

2019

PORTABLE PUMPS CATALOG



VISIT THE NEW
ONLINE STORE
🇨🇦 [SHOP.WATERAX.CA](https://shop.waterax.ca)

WATERAX 
WE MOVE WATER



TABLE OF CONTENT

MARK-3® Portable Fire Pump.....	10
BB-4® High-Pressure Portable Fire Pump	14
B2X™ Mid-Range Portable Fire Pump.....	16
Diesel Pumps.....	18
VERSAX® Multipurpose Portable Fire Pump	20
MINI-STRIKER® Lightweight Portable Fire Pump	22
STRIKER™ High-Pressure Portable Fire Pump	24
BACKPAX™ Hand Pumps	26
Drip Torch	29
Pump Tool Kit	30
Fuel Tanks	32
Fire Hoses	34
Water Handling Accessories	40
Limited Warranty.....	56
Terms and Conditions	58

COMPANY PROFILE

Trusted by wildland firefighters around the world, WATERAX sets the industry standard by developing innovative portable fire pumps and water-handling equipment designed to withstand demanding applications and rugged environments. With a time-tested legacy of reliability, WATERAX carries on its mission to place powerful, precision-engineered pumps into the hands of the men and women who need to move water to protect our lives and communities from the ravages of wildfires.

Benchmarks in the wildland firefighting community, our trustworthy MARK-3® and BB-4® centrifugal fire pumps have been top sellers and established leaders for generations. Many pumps sold decades ago are still in operation today, and are maintained with genuine spare parts.

WE'VE GOT YOUR BACK.

A product is only as good as the service behind it. At WATERAX, we back our quality products with steadfast service. Trust us to be there when you need us.

Quality. Reliability. Trust. Our pumps are as tested and proven as the men and women who use them every day.



Trusted by wildland firefighters since the 1920s

WATERAX 
WE MOVE WATER



COMPANY HISTORY

Lumbermen, foresters, loggers, government agencies, and all concerned parties consider fire the leading risk to the timber and pulp industries, and to forest preservation. They've recognized for many years that the successful suppression of fires combines SPEED and WATER, and that effective equipment must provide for quick transportation and the powerful application of water.

WATERAX HAS A LONG, PROUD, AND EXCITING HISTORY



1898

Montreal native John Colquhoun Watson Jack founds Watson Jack & Co

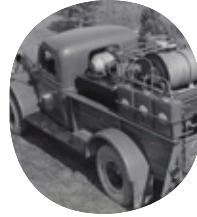

1954

Watson Jack & Co and its F H Hopkins subsidiary are acquired by B J Coghlin & Co Ltd

1925

John Colquhoun Watson Jack introduces a powerful 200 PSI portable fire pump called the WAJAX (an acronym of his name)



1959

The company is renamed Wajax Equipment Ltd





Early 1980s

Pacific Pumpers changes its name to Wajax-Pacific Fire Equipment Inc

In the ensuing years the company expands beyond wildland fire control to become an industry-leading manufacturer of firefighting equipment for the US industrial and marine markets

1995

Wildfire Fire Equipment Inc, a newly formed company, purchases Wajax Ltd's Fire Control Division



2014

Wildfire Environmental Inc. changes its name to WATERAX INC.



2000

Wildfire Fire Equipment Inc. is acquired by Tyco International

1964

Wajax Ltd acquires Pacific Marine's fire division and is renamed PacificPumpers Inc

This move solidifies Wajax Ltd's position as the leading North American manufacturer of forest fire protection products

The MARK-3® brand is introduced and rapidly becomes the standard portable fire pump for wildland, used by forestry agencies around the world

1983

Wajax Ltd sets up its Fire Control Division, combining Wajax-Pacific Fire Equipment Inc and Montreal-based Wajax Manufacturing

2010

Wildfire is acquired through a management buyout and renamed to Wildfire Environmental Inc.

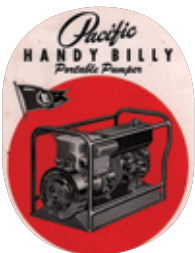

Today, the WATERAX brand harnesses the powerful essence of the historical names Watson & Jack Co, Wajax, and Wildfire. By returning to its roots, WATERAX is aligning itself with the original purpose of the company, with a new identity that communicates the core nature of our manufacturing activities and our distinctive portable pump products brand.

WATERAX products are characterized by multi-stage centrifugal pump ends designed to move water while generating high pressure to meet the difficult requirements of wildland firefighting.

THE WATERAX WAY

WATERAX is proud to continue its almost century-long tradition of designing, manufacturing and supporting high-performance and durable portable pumps. The key to its success lies in its ability to craft high quality components which form the cornerstone of superior and dependable pump performance.

DETACHABLE MULTI-STAGE PUMP ENDS

WATERAX performance and dependability come from our superior multi-stage pump end design that provides unrivaled pressure and volume.

- › Unique blister resistant mechanical rotary seal to prolong pump end longevity.
- › Maintenance free sealed bearing to avoid the need for greasing the pump end in the field.
- › Anodized aluminium impellers and pump body which eliminate galvanic corrosion common with bronze impellers.

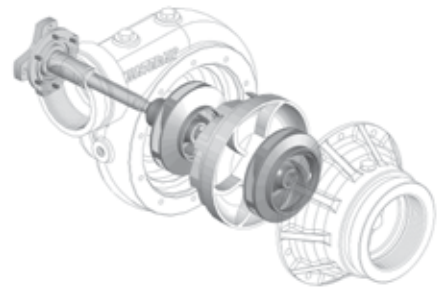

LOW MAINTENANCE DRIVE ASSEMBLY

Originally designed for the BB-4®, the WATERAX maintenance-free drive assembly has been time-tested under the most difficult conditions and proven to be dependable and reliable for more than 40 years.

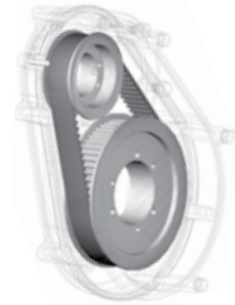

INNOVATIVE QUICK-RELEASE CLAMP

Our innovative pump end quick release clamp provides ease of maintenance without having to disassemble the complete unit, thus significantly reducing equipment downtime, which can prove crucial in emergency situations.

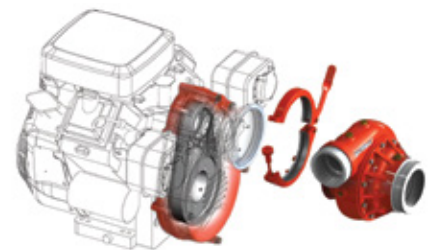

CONVENIENT 2-IN-1 SYSTEM

The WATERAX 2-in-1 system enables the easy interchanging of pump ends in the field. The platform is also compatible with either a high-pressure or a mid-range pump end, providing users with maximal performance flexibility at the lowest possible cost.

THE WATERAX PLATFORM

WATERAX offers a complete line of high performance pump ends suited to meet the most difficult water handling requirements. The WATERAX platform is composed of a low maintenance drive assembly, a Mid-Range pump end and three high-pressure pump ends. The platform's unique feature is its quick release clamp system which allows for the hook up of any WATERAX pump end to its drive assembly as well as almost instantaneous pump end detachment and interchange. This reduces equipment downtime, increase its flexibility and significantly cuts costs. These components are ideal for original equipment manufacturers looking to adapt high quality pump ends to their respective fire apparatus.

HIGH-PRESSURE PUMP ENDS

The WATERAX high-pressure centrifugal pump ends are offered in 4-stage, 3-stage, and 2-stage configurations. They deliver pressure up to 440PSI (30.3 BAR) and flows reaching 106 GPM (401 L/min) and are ideal pump ends for moving water over long distance and high elevation.

MID-RANGE PUMP END

The WATERAX B2X™ is a Mid-Range 2-stage centrifugal pump end that delivers pressure up to 200 PSI (13.8 BAR) and flows reaching 300 US GPM (1136 L/min). A strong show of pressure and volume it is the ideal pump end for dual attack lines dedicated to wildland & urban interface operations.

It is also perfect for high volume remote watering, booster line applications, brush trucks, slip-on units and for uphill tandem operations. The suction and discharge use a combination of Victaulic and national pipe threads to facilitate its plumbing.

DRIVE ASSEMBLY

WATERAX offers an outstanding drive assembly that boosts the performance of pump ends. The drive assembly increases the speed of pump revolutions resulting in increased pressure and volume. The drive assembly is used with the WATERAX quick release clamp to enable the coupling of the drive assembly to the desired pump end.



18-16S / 3-Stage



12-16S / 4-Stage



25-16S / 2-Stage



B2X / 2-Stage



C-7220 / Drive Assembly

THE WATERAX SERIES

WATERAX carries on its mission to place powerful, precision-engineered pumps into the hands of our heroic wildland firefighters to move water to protect our forests and communities from the ravages of wildfires.

MARK-3[®] SERIES

The 4-stage detachable pump end patented in 1958 gave birth to the iconic **MARK-3[®]**. Since WAJAX first introduced the **MARK-3[®]** in 1964, it has been the standard wildland portable fire pump used by forestry agencies around the world. A truly outstanding and reliable performer, the **MARK-3[®]** fire pump is designed to withstand the rigors of firefighting and it is at the core of most water delivery system in wildland operations.



BB-4[®] SERIES

The **BB-4[®]** Series is a full line of high-pressure centrifugal pumps that has been used by forest agencies for over 40 years in Type 6 brush trucks. It has become the weapon of choice in wildland operations. The **BB-4[®]** comes in portable & vehicle mounted configurations and all models feature a unique greaseless sealed bearing and a blister-resistant mechanical rotary seal. The 4-stage pump end on the **BB-4[®]** is identical to the pump end on the **MARK-3[®]** unit which greatly reduces your spare parts inventory and improves your ability to respond to unforeseen equipment damage.



BB-4[®] DIESEL

The legendary **BB-4[®]** is now available in Diesel! Strong enough to operate as a source pump for tandem and parallel pumping, it is also optimal for direct attack firefighting, remote watering, sprinkler systems, and is a popular choice for slip-on units. The 4-stage pump end on the **BB-4[®]** is identical to the pump end on the **MARK-3[®]** unit, which greatly reduces your spare parts inventory and improves your ability to respond to unforeseen equipment damage.



B2X[™] SERIES

The **B2X[™]** Series is a full line of Mid-Range portable pumps that delivers the best performance of its class with minimal operating costs. The **B2X[™]** comes in portable & vehicle mounted configurations and is powered by Briggs & Stratton Vanguard or Honda 4-stroke engines.



B2X[™] DIESEL

A strong show of both pressure and volume makes it the ideal pump for vehicle mounted applications dedicated to municipal and wildland urban interface operations. The WATERAX quick release clamp provided on the **B2X[™]** pump provides ease of maintenance without having to disassemble the complete pump unit thus significantly reducing equipment downtime.



VERSAX[®]

SERIES

The **VERSAX[®]** is a multipurpose self-priming pump. This unit is driven by a 6 HP or 9 HP Honda engine. This workhorse can be used as a portable pump or on a slip-on unit. Its compact design makes it ideal for a variety of applications such as firefighting, tank filling, water transfers and ATV slip-ons.



STRIKER[™]

SERIES

The **STRIKER[™]** Series is a full line of high-pressure fire pumps powered by Honda 4-stroke engines. Applications include cabin protection, skid units and snow making.



MINI-STRIKER[®]

SERIES

The **MINI-STRIKER[®]** pump pairs a reliable single stage pump end with the Honda 4-stroke 2.1 HP engine. Extremely portable and lightweight this mini powerhouse performs well when used by itself or in tandem with other pumps, and is a very popular choice for entry level skid applications.



BACKPAX[®]

SERIES

The **BACKPAX[™]** series is a line of backpack pumps that were conceived with the comfort and safety of the user in mind. They come with a rigid or flexible tank and are equipped with an ergonomic and sturdy brass hand pump.





MARK-3[®] SERIES

Since 1964 when the MARK-3[®] was first introduced by WAJAX, after the 4-stage detachable pump end was patented in 1958, it has been the standard wildland portable fire pump used by forestry agencies around the world. A truly outstanding and reliable performer, the MARK-3[®] fire pump is designed to withstand the rigors of firefighting and it is at the core of most water delivery system in wildland operations.

Always the benchmark in terms of performance, reliability and durability, the MARK-3[®] benefited from a series of improvements to its key components namely a Nikasil coated cylinder, an impregnated crankcase and a maintenance-free pump end.

The improved MARK-3[®] successfully passed the USDA Forest Service 100 hours endurance test in San Dimas and has been requalified under QPL Number 274-001.



APPLICATIONS

- Firefighting
- Tank filling
- High head general water transfer
- Boom spraying
- Irrigation
- ATV slip-ons

FEATURES & BENEFITS

- Twin impeller design provides additional pressure for longer & higher pumping applications
- Pump casing and diffusers manufactured from quality corrosion resistant grade aluminum for long life
- Nylon glass fiber reinforced impellers are fully corrosion proof and lightweight
- 3-way discharge port for easy installation
- Powder coated casing for added corrosion resistance
- Self-priming for more versatile installation options
- Easy access to drain port
- Fastwire™ included on all vehicle mounted units.
- EPA Certified

SHOP
NOW

ITEM NO.	DESCRIPTION
100101	MK3 MARK-3[®] V2 HIGH-PRESS FIRE PUMP 4-STG
100099	MK3-QS MARK-3[®] V2 HIGH-PRESS FIRE PUMP 4-STG QC, SUCT. ADAPT
100102	MK3-TQS MARK-3[®] V2 HIGH-PRESS FIRE PUMP 4-STG FUEL TANK, QC, SUCT. ADAPT
100105	MK3-U MARK-3[®] V2 HIGH-PRESS FIRE PUMP 4-STG SAE FUEL CON, NH ADPT
100106	MK3-UT MARK-3[®] V2 HIGH-PRESS FIRE PUMP 4-STG SAE FUEL CON, NH ADPT, METAL FUEL TANK,
100107	MK3-UTK MARK-3[®] V2 HIGH-PRESS FIRE PUMP 4-STG SAE FUEL CON, NH ADPT, METAL FUEL TANK, PRMR, TOOL
100120	MK3-B2 MARK-3[®] V2 MID-RANGE FIRE PUMP, 2-STG
100109	MK3-UB2 MARK-3[®] V2 MID-RANGE FIRE PUMP, 2-STG SAE FUEL CON

MARK-3®

PORTABLE HIGH-PRESSURE FIRE PUMP

When fires occur in remote locations such as wildland forests and mountainous regions, you need a lightweight, robust and compact portable pump, which will allow you to relocate quickly while minimizing fatigue. The MARK-3®, with its unmatched power-to-weight ratio and two-stroke engine, is your ideal solution.

WATERAX acquired the intellectual property and the rights to manufacture the long-lasting 185cc from ROTAX®. We invested heavily in new tooling and major improvements on key engine components in order to make the 185cc engine lighter and more durable.

The WATERAX 185cc engine features the following enhancements:

- Nikasil-coated cylinder
- Impregnated crankcase
- Composite cooling fan
- Longer recoil rope



MARK-3®
Portable

MARK-3-B2

PORTABLE LIGHTWEIGHT HIGH PRESSURE 2-STAGE FIRE PUMP

The WATERAX MARK-3-B2 portable fire pump pairs a reliable Mid-Range 2-stage pump end with a 2-stroke 10 hp engine. Its compact power makes it the ideal pump for higher volume remote watering, tandem and parallel pumping.

The WATERAX quick release clamp provided on the MARK-3-B2 pump lets you replace a damaged pump end in the field with minimal equipment downtime. The pump mating and clamp mechanism is identical to the mating on the MARK-3® 4-stage and BB-4® units, which means you can change the MARK-3-B2 medium pressure pump end for the higher pressure WATERAX 4-stage pump end as needed to combat pressure loss due to rugged terrain, very long hose lays or high altitudes.

Emergency rescue equipment - Exempt from emission standards under 40 CFR 1054.660

APPLICATIONS

- Structure attack line firefighting
- High volume supply lines
- Tandem pumping over long distances
- Parallel pumping for higher volumes



MARK-3-B2

FEATURES AND BENEFITS

- Quick release clamp and swappable pump ends for minimal equipment downtime and inventory
- Aluminium alloy pump components and anodized parts for lighter weight and greater resistance to corrosion

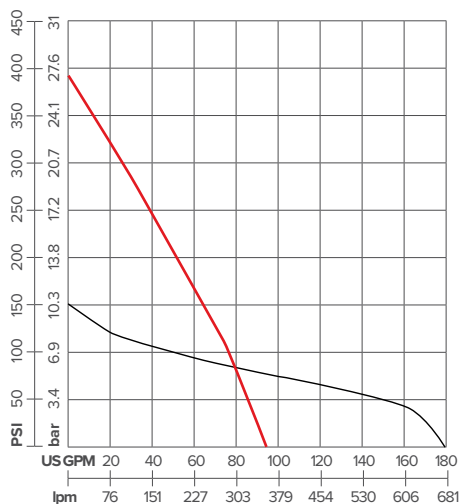

MARK-3

HONDA
ENGINES

Engine brand: WATERAX 185cc
Engine type: Gas 2-Stroke

Flow rate at specified pressure

Maximum pressure: **380 PSI** (26.2 bar)
Free flow: **98 US GPM** (371 lpm)
Maximum head: **878'** (268 m)
Weight: **58 lbs** (27 kg)

Flow Rate			Pressure		
US GPM	(lpm)	@	PSI	(bar)	
78	(295)	@	100	(6.9)	
65	(246)	@	150	(10.3)	
38	(144)	@	250	(17.2)	

MARK-3-B2

HONDA
ENGINES

Engine brand: WATERAX 185cc
Engine type: Gas 2-Stroke

Flow rate at specified pressure

Maximum pressure: **155 PSI** (10.7 bar)
Free flow: **180 US GPM** (681 lpm)
Maximum head: **358'** (109 m)
Weight: **58 lbs** (27 kg)

Flow Rate			Pressure		
US GPM	(lpm)	@	PSI	(bar)	
25	(95)	@	125	(8.6)	
65	(246)	@	100	(6.9)	
150	(568)	@	50	(3.4)	



HIGH-PRESSURE PUMP ENDS

WATERAX offers a complete line of high performance pump ends suited to meet the most difficult water handling requirements. The performance and dependability of our pumps come from our superior multi-stage pump end design, patented in 1958, that provides unrivaled pressure and volume.

- Unique blister-resistant mechanical rotary seal to prolong pump end longevity
- Maintenance-free sealed bearing to avoid the need for greasing the pump end in the field
- Anodized aluminium impellers and pump body which eliminate galvanic corrosion common with bronze impellers



WATERAX high-pressure centrifugal pump ends are offered in 4-stage, 3-stage and 2-stage configurations. They deliver pressure up to 440 PSI (30.3 bar) and flows reaching 310 US GPM (1173 lpm) and are ideal pump ends for moving water over long distances and high elevations.

Visit the WATERAX online store to purchase exclusive genuine spare parts for your multi-stage high-pressure centrifugal pump ends.

Access all related documents, such as support documents, tech notes, data sheets, owner's manuals and educational videos at the WATERAX online store.

SHOP FOR GENUINE SPARE PARTS ONLINE
shop.waterax.ca

WATERAX 
WE MOVE WATER

BB-4[®] SERIES

The BB-4[®] Series is a full line of high-pressure centrifugal pumps that has been used by forest agencies for over 40 years in Type 6 brush trucks. It has become the weapon of choice in wildland operations. The BB-4[®] comes in portable and vehicle-mounted configurations and all models feature a unique greaseless sealed bearing and a blister-resistant mechanical rotary seal. A unique feature of the BB-4[®] pump is the quick-release pump end that is interchangeable with the MARK-3[®] pump. The product feature greatly reduces your spare parts inventory and allows for quick infield swap outs.



APPLICATIONS

- Slip-on units
- Attack line firefighting
- Long hose lay for remote watering during firefighting operations
- High-elevation firefighting in mountainous areas
- High-pressure provides accuracy in flow trajectory
- Tandem pumping over long distances
- Parallel pumping for higher volumes

FEATURES & BENEFITS

- Quick release clamp and detachable pump end for minimal equipment downtime and inventory
- Unique blister resistant mechanical rotary seal to prolong pump end longevity
- Sealed bearing to eliminate pump end greasing in the field
- Rugged and reliable "maintenance free" drive assembly
- Aluminium alloy pump components and anodized parts for lighter weight and greater resistance to corrosion
- Fastwire™ plug-n-play feature is included on all vehicle mounted units.
- EPA Certified

**SHOP
NOW**

ITEM NO.	DESCRIPTION
100018	BB-4-23PXT HIGH-PRESS BB-4[®] PUMP, 4-STG, B&S23 CARRY FRAME, EXHAUST PRIMER, FUEL TANK, CTRL
100027	BB-4-23VX HIGH-PRESS BB-4[®] FIRE PUMP, 4-STG, B&S23 BASE MOUNT, FAST WIRE, EXHAUST PRIMER
100028	BB-4-23V HIGH-PRESS BB-4[®] FIRE PUMP, 4-STG, B&S23 BASE MOUNT, FAST WIRE
100032	BB-4-21H HIGH-PRESS BB-4[®] PUMP, 4-STG, HONDA GX630 BASE MOUNT, FASTWIRE
100034	BB-4-18PTC HIGH-PRESS BB-4[®] PUMP, 4-STG, B&S18T CARRY FRAME, FUEL TNK, CTRL
100025	BB-4-18V HIGH-PRESS BB-4[®] PUMP, 4-STG, B&S18 BASE MOUNT, FASTWIRE

More product configurations are available. See us on line at www.waterax.com



Portable



Vehicle Mount Horizontal Drive



Vehicle Mount Vertical Drive

BB-4-18P



Engine brand: Briggs & Stratton Vanguard
Engine type: Gas 4-Stroke

Flow rate at specified pressure

Maximum pressure: **440 PSI** (30.3 bar)
Free flow: **104 US GPM** (394 lpm)
Maximum head: **1015'** (309 m)
Weight: **153 lbs** (69 kg) – **194 lbs** (88 kg)

Flow Rate		Pressure		
US GPM	(lpm)	@	PSI	(bar)
99	(375)	@	150	(10.3)
80	(303)	@	250	(17.2)
49	(185)	@	350	(24.1)

BB-4-21H



Engine brand: Honda GX630
Engine type: Gas 4-Stroke

Flow rate at specified pressure

Maximum pressure: **440 PSI** (30.3 bar)
Free flow: **106 US GPM** (401 lpm)
Maximum head: **1015'** (309 m)
Weight: **169 lbs** (77 kg)

Flow Rate		Pressure		
US GPM	(lpm)	@	PSI	(bar)
105	(397)	@	150	(10.3)
94	(356)	@	250	(17.2)
65	(246)	@	350	(24.1)

BB-4-23VX



Engine brand: Briggs & Stratton Vanguard
Engine type: Gas 4-Stroke

Flow rate at specified pressure

Maximum pressure: **440 PSI** (30.3 bar)
Free flow: **106 US GPM** (401 lpm)
Maximum head: **1015'** (309 m)
Weight: **154 lbs** (70 kg) – **194** (88 kg)

Flow Rate		Pressure		
US GPM	(lpm)	@	PSI	(bar)
103	(390)	@	150	(10.3)
94	(356)	@	250	(17.2)
65	(246)	@	350	(24.1)

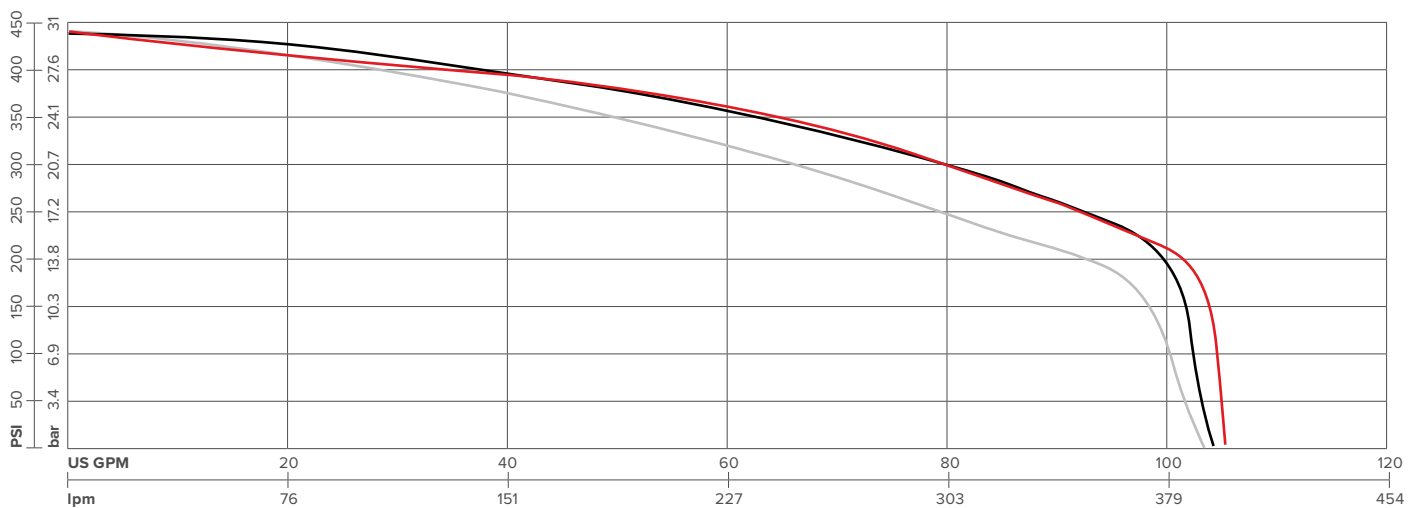



B2XTM SERIES



The B2XTM is a vehicle-mounted mid-range fire pump dedicated to wildland and urban interface operations. The B2XTM delivers the best performance of its class with minimal operating costs. Unlike other pumps, the B2XTM uses a low maintenance drive belt system that provides efficient and dependable performance. Combining both pressure and volume it is ideal for dual attack lines operations, remote water transfer and structural firefighting.

It provides a good balance of pressure and flow, providing fire fighters with versatility in attack and water transfer operations. The higher pressures that the WATERAX fire pumps are known for also provide better ground sweep and monitor performance, in addition to excellent flow rates.

APPLICATIONS

- Vehicle mounted applications
 - Brush trucks
 - Initial attack units
 - Slip-on units
- Structure protection
- Water transfer
- Boat fire pump
- Booster reel
- Dual 1-1/2" attack lines
- 2-1/2" supply line

FEATURES & BENEFITS

- Quick release clamp and detachable pump end for ease of maintenance and minimal equipment downtime
- Heat-resistant "maintenance free" mechanical rotary seal to prolong pump end longevity
- Sealed bearing to eliminate pump end greasing in the field
- Rugged and reliable "maintenance free" drive assembly
- Aluminum alloy pump components and anodized parts for lighter weight and greater resistance to corrosion
- Fastwire[™] plug-n-play feature is included on all vehicle mounted units.
- EPA Certified

**SHOP
NOW**

ITEM NO.	DESCRIPTION	
100073	B2X-23PXT	MID-RANGE FIRE PUMP, 2-STG, B&S23 CARRY FRAME, EXHAUST PRIMER, FUEL TNK, CTRL
100072	B2X-23V	MID-RANGE FIRE PUMP, 2-STG, B&S23 BASE MOUNT, FAST WIRE
100067	B2X-21H	MID-RANGE FIRE PUMP, 2-STG, HONDA GX630 BASE MOUNT, FAST WIRE
100070	B2X-18PTC	MID-RANGE FIRE PUMP, 2-STG, B&S18T CARRY FRAME, FUEL TNK, CTRL
100100	B2X-18VXC	MID-RANGE PUMP, 2-STG, B&S18 BASE MOUNT, PORTABLE EXHAUST PRIMER, CTRL
100071	B2X-18VX	MID-RANGE FIRE PUMP, 2-STG, B&S18 BASE MOUNT, FAST WIRE, EXHAUST PRIMER

More product configurations are available. See us on line at www.waterax.com



Portable



Vehicle Mount Horizontal Drive



Vehicle Mount Vertical Drive

B2X-18P



Engine brand: Briggs & Stratton Vanguard
Engine type: Gas 4-Stroke

Flow rate at specified pressure

Maximum pressure: **190 PSI** (13.1 bar)
Free flow: **300 US GPM** (1136 lpm)
Maximum head: **438'** (134 m)
Weight: **153 lbs** (69 kg) – **194 lbs** (88 kg)

Flow Rate			Pressure	
US GPM	(lpm)	@	PSI	(bar)
255	(965)	@	50	(3.4)
155	(587)	@	100	(6.9)
65	(246)	@	150	(10.3)

B2X-21H



Engine brand: Honda GX630
Engine type: Gas 4-Stroke

Flow rate at specified pressure

Maximum pressure: **200 PSI** (13.8 bar)
Free flow: **300 US GPM** (1136 lpm)
Maximum head: **461'** (141 m)
Weight: **169 lbs** (77 kg)

Flow Rate			Pressure	
US GPM	(lpm)	@	PSI	(bar)
275	(1041)	@	50	(3.4)
215	(814)	@	100	(6.9)
112	(424)	@	150	(10.3)

B2X-23V



Engine brand: Briggs & Stratton Vanguard
Engine type: Gas 4-Stroke

Flow rate at specified pressure

Maximum pressure: **200 PSI** (13.8 bar)
Free flow: **300 US GPM** (1136 lpm)
Maximum head: **461'** (141 m)
Weight: **157 lbs** (71 kg) – **194 lbs** (88 kg)

Flow Rate			Pressure	
US GPM	(lpm)	@	PSI	(bar)
285	(1079)	@	50	(3.4)
215	(814)	@	100	(6.9)
100	(379)	@	150	(10.3)

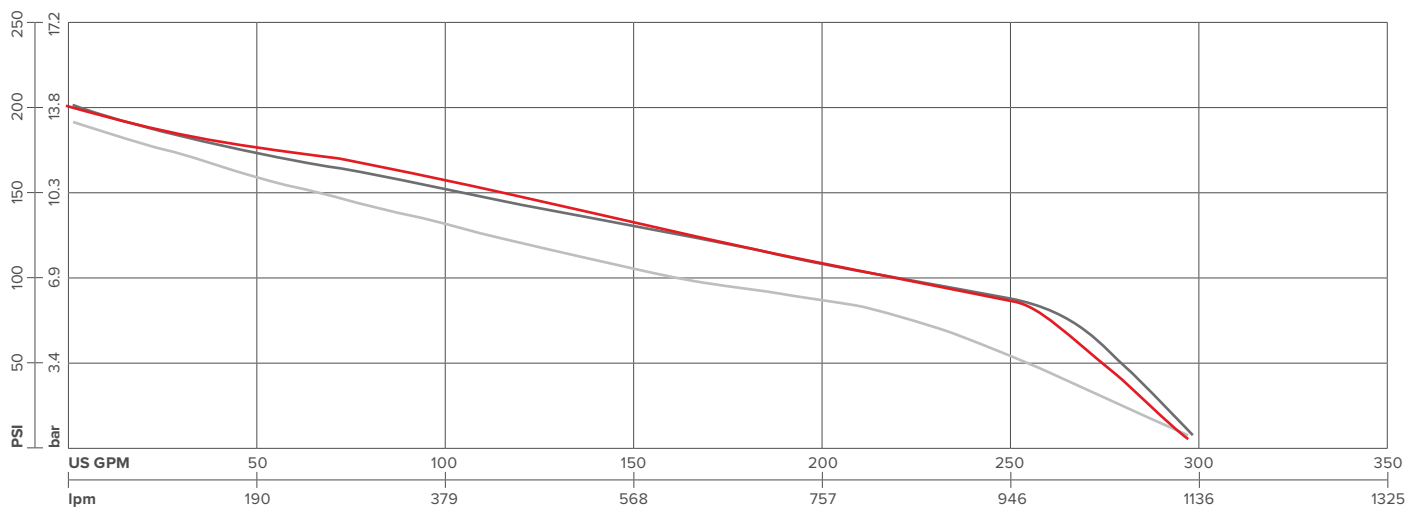

BB-4[®] DIESEL

The Diesel BB-4 pump pairs a reliable high performance 4-stage centrifugal pump end with a powerful Kubota 24.8 HP diesel engine. Strong enough to operate as a source pump for tandem and parallel pumping, it is also optimal for direct attack firefighting, remote watering, sprinkler systems, and is a popular choice for slip-on units.

The 4-stage pump end on the BB-4[®] is identical to the pump end on the MARK-3[®] unit, which greatly reduces your spare parts inventory and improves your ability to respond to unforeseen equipment damage.



APPLICATIONS

- Brush Trucks
- Attack-line firefighting
- Long hose lay for remote watering during firefighting operations
- High-elevation firefighting in mountainous areas
- High pressure provides accuracy in flow trajectory
- Tandem pumping over long distances
- Parallel pumping for higher volumes

FEATURES AND BENEFITS

- Quick release clamp and detachable pump end for minimal equipment downtime and inventory
- Sealed bearing to eliminate pump end greasing in the field
- Rugged and reliable "maintenance free" drive assembly
- Aluminium alloy pump components and anodized parts for lighter weight and greater resistance to corrosion
- Unique blister-resistant mechanical rotary seal
- EPA Certified

BB-4-D902

This high-pressure fire pump has been used by forest agencies in Type 6 brush trucks for over 40 years. The BB-4[®] Diesel comes in a vertical pump drive mount as standard, with a horizontal-drive mount optional. It is powered by the Kubota D902 Super Mini-Series 3-cylinder liquid-cooled diesel engine.

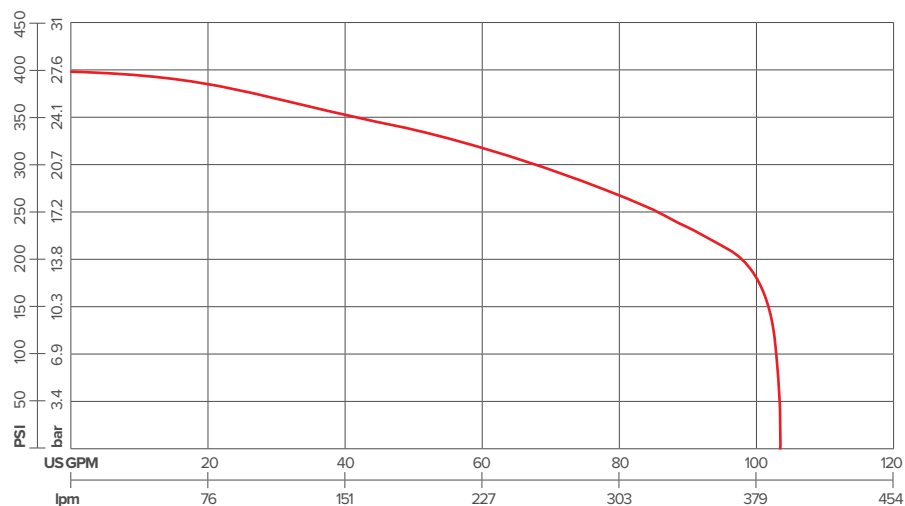

D902-E4B



Engine brand: Kubota D902-E4B
Engine type: Diesel

Flow rate at specified pressure

Maximum pressure: **395 PSI** (27.2 bar)
Free flow: **106 US GPM** (401 lpm)
Maximum head: **911'** (278 m)
Weight: **280 lbs** (127 kg)

Flow Rate			Pressure	
US GPM	(lpm)		PSI	(bar)
103	(390)	@	150	(10.3)
95	(360)	@	250	(17.2)
55	(208)	@	350	(24.1)

SHOP
NOW

ITEM NO.	DESCRIPTION
100095	BB-4-D902V HIGH-PRESS BB-4@ PUMP, 4-STG, DIESEL VERTICAL DRIVE, LEG MOUNTS, HARNESS
100097	BB-4-D902H HIGH-PRESS BB-4@ PUMP, 4-STG, DIESEL HORIZONTAL DRIVE, LEG MOUNTS, HARNESS

B2X™ DIESEL

The Diesel B2X pump unit is a mid-range fire pump ideal for brush trucks used in wildland and urban interface operations.

A combination of pressure and volume makes it the ideal pump for vehicle-mounted applications dedicated to municipal and in wildland-urban interface areas. The WATERAX quick-release clamp provided on the B2X™ pump provides ease of maintenance without having to disassemble the complete pump unit thus significantly reducing equipment downtime.



APPLICATIONS

- Vehicle-mounted applications
 - Brush trucks
 - Initial attack units
 - Slip-on units
- Structure protection
- Water transfer
- Boat fire pump
- Booster reel
- 2x 1-1/2" simultaneous attack lines
- 2-1/2" supply line

FEATURES AND BENEFITS

- Versatile fire pump offering the firefighting capability, high-pressure hose reel, multiple attack lines, and water transfer capabilities.
- Quick release clamp and detachable pump end for ease of maintenance and minimal equipment downtime.
- Rugged and reliable "maintenance free" drive assembly
- Aluminum alloy pump components and anodized parts for lighter weight and greater resistance to corrosion
- EPA Certified
- Heat-resistant and maintenance-free mechanical rotary seal

B2X-D902

The B2X™ Diesel comes in a vertical pump drive mount as standard with a horizontal drive mount optional. It is powered by the Kubota D902 Super Mini-Series 3-cylinder liquid cooled diesel engine.

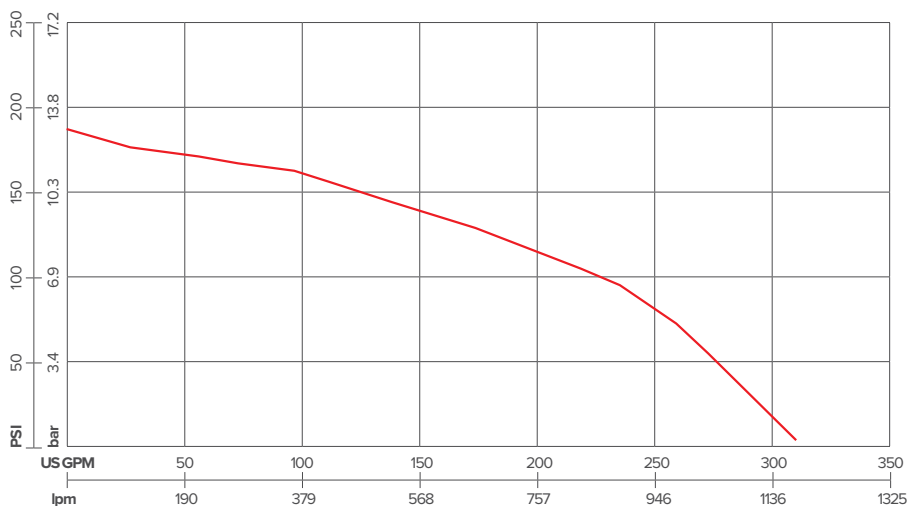

D902-E4B



Engine brand: Kubota D902-E4B
Engine type: Diesel

Flow rate at specified pressure

Maximum pressure: **180 PSI** (12.4 bar)
Free flow: **310 US GPM** (1173 lpm)
Maximum head: **415'** (127 m)
Weight: **280 lbs** (127 kg)

Flow Rate			Pressure	
US GPM	(lpm)		PSI	(bar)
274	(1037)	@	50	(3.4)
220	(833)	@	100	(6.9)
112	(424)	@	150	(10.3)

ITEM NO.	DESCRIPTION
100096	B2X-D902V MID-RANGE FIRE PUMP, 2-STG, DIESEL VERTICAL DRIVE, LEG MOUNTS, HARNESS
100098	B2X-D902H MID-RANGE FIRE PUMP, 2-STG, DIESEL HORIZONTAL DRIVE, LEG MOUNTS, HARNESS

SHOP
NOW

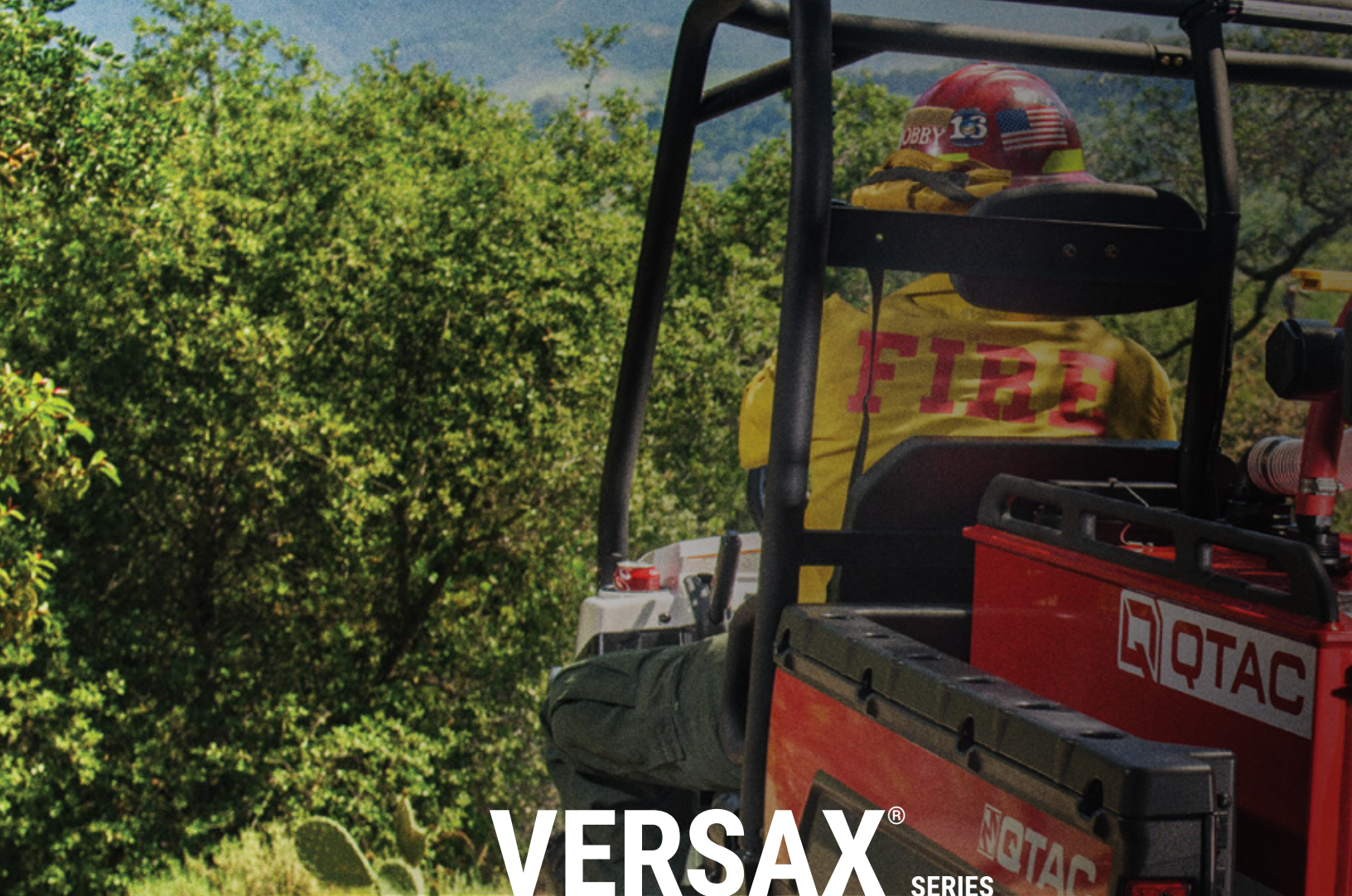

VERSAX[®] SERIES

The VERSAX[®] is a versatile, rugged, and economical twin-impeller self-priming pump powered by a Honda engine for superior water transfer performance as well as the ability to combat fire from a greater distance and elevation. The VERSAX[®] is a multipurpose fire pump that can also be used for other applications such as tank filling, water transfers and ATV slip-on units.



APPLICATIONS

- Firefighting
- Tank filling
- High head general water transfer
- Boom spraying
- Irrigation
- ATV slip-ons

FEATURES & BENEFITS

- Twin impeller design provides additional pressure for longer & higher pumping applications
- Pump casing and diffusers manufactured from quality corrosion resistant grade aluminum for long life
- Nylon glass fiber reinforced impellers are fully corrosion proof and lightweight
- 3-way discharge port for easy installation
- Powder coated casing for added corrosion resistance
- Self-priming for more versatile installation options
- Easy access to drain port
- Fastwire[™] included on all vehicle mounted units.
- EPA Certified

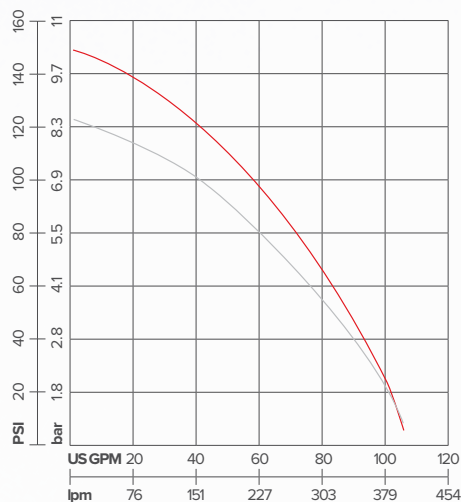

VS2-6

HONDA
ENGINES

Engine brand: Honda GX200 Series
Engine type: Gas 4-Stroke

Flow rate at specified pressure

Maximum pressure: **120 PSI** (8.3 bar)

Free flow: **105 US GPM** (397 lpm)

Maximum head: **277'** (84 m)

Weight: **56 lbs** (25 kg) – **116 lbs** (53 kg)

Flow Rate			Pressure	
US GPM	(lpm)		PSI	(bar)
83	(314)	@	50	(3.4)
63	(238)	@	75	(5.2)
38	(144)	@	100	(6.9)



Vehicle Mount



Portable

ITEM NO.	DESCRIPTION	
100110	VS2-6W VERSAX®	SELF-PRIMING PUMP 2-STG HONDA GX200 WRAP-AROUND FRAME
100113	VS2-6C VERSAX®	FIRE PUMP 2-STG HONDA GX200 CART SYSTEM WITH HOSE KIT
100093	VS2-6V VERSAX®	SELF-PRIMING PUMP 2-STG HONDA GX200 VEHICLE MOUNT
100111	VS2-9W VERSAX®	SELF-PRIMING PUMP 2-STG HONDA GX270 WRAP-AROUND FRAME
100112	VS2-9EW VERSAX®	SELF-PRIMING PMP 2-STG HONDA GX270 WRAP-AROUND FRAME, ELECTRIC START, BATTERY
100114	VS2-9C VERSAX®	FIRE PUMP 2-STG HONDA GX270 CART SYSTEM WITH HOSE KIT
100115	VS2-9EC VERSAX®	FIRE PUMP 2-STG HONDA GX270 CART SYSTEM WITH HOSE KIT, ELECTRIC START, BATTERY
100078	VS2-9EV VERSAX®	SELF-PRIMING PUMP 2-STG HONDAGX270 ELECTRIC START, FASTWIRE

**SHOP
NOW**



MINI-STRIKER[®] SERIES

The MINI-STRIKER[®] pump pairs a reliable single stage pump end with the Honda 4-stroke 2.1 HP engine. Extremely portable and lightweight this mini powerhouse performs well when used by itself or in tandem with other pumps, and is a very popular choice for entry level skid applications.

LIGHTWEIGHT HIGH-PRESSURE FIRE PUMP

The MINI-STRIKER[®] pump is driven by a Honda 4-stroke 2.1 HP engine. Its corrosion resistant aluminum components and "maintenance-free" mechanical seal, along with WATERAX quality manufacturing, ensures a highly reliable and durable pumping unit. Its light weight and portability make it a must as a pump to keep on hand for miscellaneous pumping operations.



APPLICATIONS

- Attack line firefighting
- Sprinkler operations
- Tandem pumping over long distances
- Entry level slip-on units
- Irrigation

FEATURES AND BENEFITS

- Lightweight aluminium alloy pump components
- Portable and compact
- Optional Scotty foam eductor
- Turnkey solution
- Emissions compliant; engine is CARB and EPA certified



Portable



Vehicle Mount Configuration

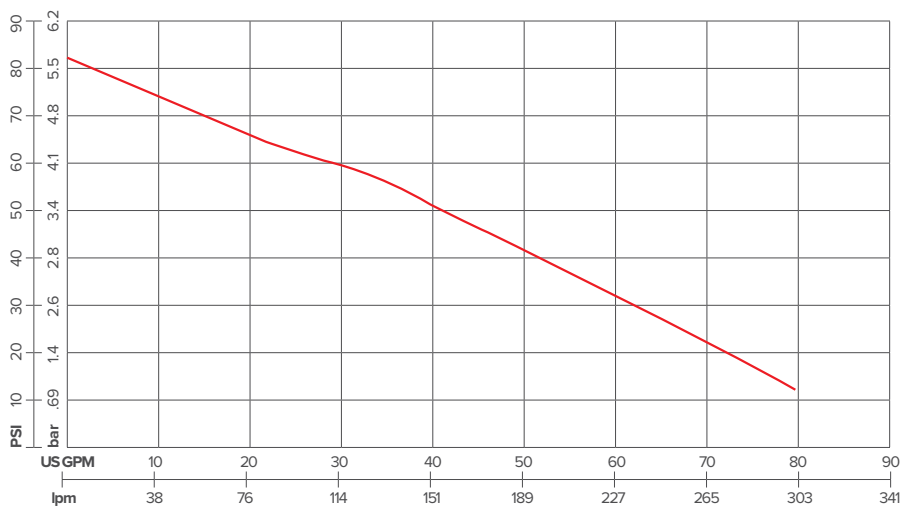

GXH50

HONDA
ENGINES

Engine brand: Honda GXH50 Series
Engine type: Gas 4-stroke

Flow rate at specified pressure

Maximum pressure: **85 PSI** (5.9 bar)

Free flow: **80 US GPM** (303 lpm)

Maximum head: **196'** (60 m)

Weight: **20 lbs** (9 kg) – **103 lbs** (47 kg)

Flow Rate			Pressure	
US GPM	(lpm)	@	PSI	(bar)
68	(257)	@	25	(1.7)
42	(159)	@	50	(3.4)
12	(45)	@	75	(5.2)

ITEM NO.	DESCRIPTION	
100053	MINI-STRIKER®	MSTR-P PUMP 1-STG GXH50 PORTABLE
100092	MINI-STRIKER®	MSTR-V FIRE PUMP 1-STG GXH50 VEHICLE
100125	MSTR-C MINI-STRIKER®	FIRE PUMP 1-STG GXH50 CART SYSTEM WITH HOSE KIT
200066	MSTR-SD MINI-STRIKER®	SKID DECK
200067	MSTR-SDF MINI-STRIKER®	SKID DECK FOAM

**SHOP
NOW**

STRIKER[®] SERIES



The STRIKER™ Series is a full line of high-pressure fire pumps powered by Honda 4-stroke engines. They are built on the same platform as the BB-4® and is composed of interchangeable parts with the MARK-3® and BB-4® which reduces spare parts inventory and improves ability to respond to unforeseen equipment damage.

APPLICATIONS

- Attack line firefighting
- Long hose lay for remote watering during firefighting operations
- High elevation firefighting in mountainous areas
- High-pressure provides accuracy in flow trajectory
- Tandem pumping over long distances
- Parallel pumping for higher volumes Slip-on units
- Snowmaking

FEATURES & BENEFITS

- Quick release clamp and detachable pump end for minimal equipment downtime and inventory
- Unique blister resistant mechanical rotary seal to prolong pump end longevity
- Sealed bearing to eliminate pump end greasing in the field
- Rugged and reliable "maintenance free" drive assembly
- Aluminium alloy pump components and anodized parts for lighter weight and greater resistance to corrosion
- Fastwire™ plug-n-play feature is included on all vehicle mounted units.
- EPA Certified

**SHOP
NOW**

ITEM NO.	DESCRIPTION
100046	STRIKER STR2-13P STRIKER-II PLUS 2-STG GX390 CARRY FRAME, HAND PRIMER, CHECK VAVLE
100045	STRIKER STR2-13V STRIKER-II SLIP PUMP 2-STG GX390 BASE MOUNT, FASTWIRE
100127	STRIKER STR2-13VS STRIKER-II SLIP PUMP 2-STG GX390 BASE MOUNT, HAND PRIMER, CHECK VALVE
100049	STRIKER STR3-13P ULTRAstriker PUMP 3-STG GX390 CARRY FRAME, FUEL TANK, HAND PRIMER, CHECK VAVLE
100047	STRIKER STR3-13V ULTRA-SLIP PUMP 3-STG GX390 BASE MOUNT, FASTWIRE
100048	STRIKER STR3-13S ULTRASNOW PUMP 3-STG GX390 CARRY FRAME



STRIKER II®
HIGH-PRESSURE 2-STAGE FIRE PUMP

The WATERAX STRIKER II®, pairs a reliable 2-stage pump end with a Honda 4-stroke engine. It can be used by itself, in tandem or in parallel with other WATERAX pumps. It is also a very popular choice for slip-on applications.



Portable

STRIKER-3
HIGH-PRESSURE 3-STAGE FIRE PUMP

The WATERAX STRIKER-3 also known as ULTRAstriker® provides additional pressure useful to overcome longer distance and elevation. It can be used by itself, in tandem or in parallel with other WATERAX pumps.



Vehicle Mount

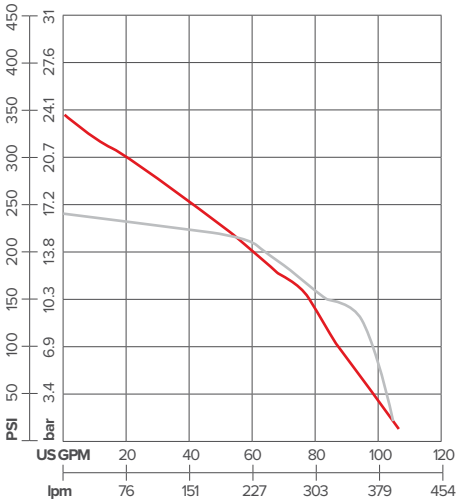

STRIKER II



Engine brand: Honda, GX390 Series
Engine type: Gas 4-Stroke

Flow rate at specified pressure
Maximum pressure: **230 PSI** (15.9 bar)
Free flow: **105 US GPM** (397 lpm)
Maximum head: **531'** (162 m)
Weight: **128 lbs** (58 kg)

Flow Rate			Pressure	
US GPM	(lpm)		PSI	(bar)
97	(367)	@	100	(6.9)
79	(299)	@	150	(10.3)
58	(220)	@	200	(13.8)

STRIKER-3



Engine brand: Honda, GX390 Series
Engine type: Gas 4-Stroke

Flow rate at specified pressure
Maximum pressure: **345 PSI** (23.8 bar)
Free flow: **102 US GPM** (386 lpm)
Maximum head: **796'** (243 m)
Weight: **128 lbs** (58 kg)

Flow Rate			Pressure	
US GPM	(lpm)		PSI	(bar)
87	(329)	@	100	(6.9)
75	(284)	@	150	(10.3)
38	(144)	@	250	(17.2)

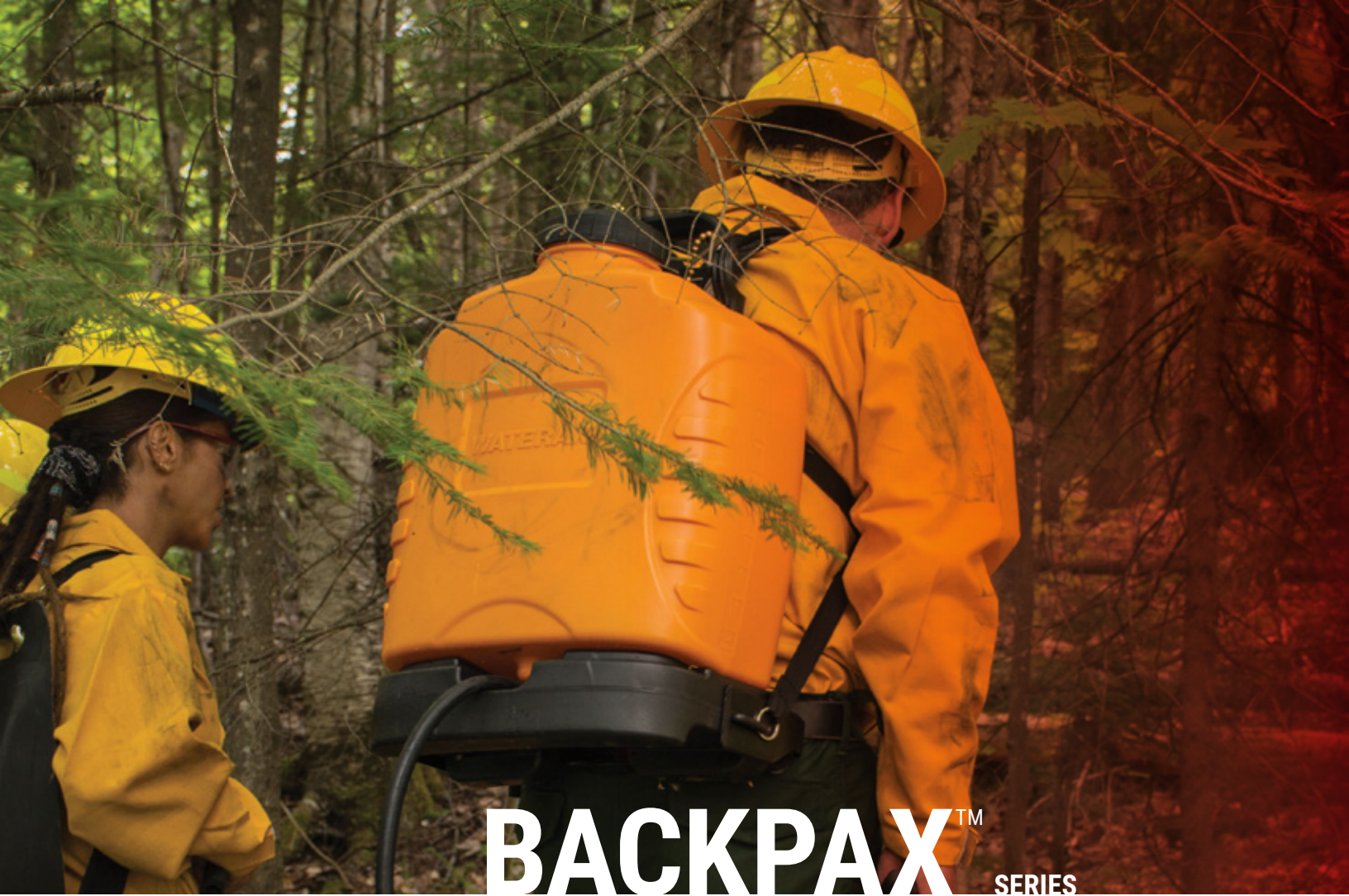

BACKPAX™ SERIES

The BACKPAX™ series is a line of backpack fire pumps that was designed with the comfort and safety of the user in mind. They feature either a rigid or flexible tank and are equipped with an ergonomic and sturdy brass hand pump.

WATERAX has been manufacturing backpack fire pumps for firefighters for over half a century. These units are critical to fighting brush, grass, and rubbish fires as well as hot spotting and mop-up operations for forest fires. They are also very useful for overhauling in structure fires. Our backpack fire pumps have evolved over the years to include the latest and greatest features in order to carry on the legacy of equipping our firefighters with the nothing but the best.



APPLICATIONS

- Hot Spotting
- Mop-up
- Prescribed burn operations
- Campsite protection
- Industrial operations

FEATURES & BENEFITS

- Durable brass elbow fitting for hose connection to tank
- Carry handle also functions as storage for the hand pump
- Comfortable shoulder straps
- Resistant to UV and ozone



OT-4NX

POLY BACKPACK WITH BRASS HAND PUMP

The OT-4NX is a poly backpack made of lightweight yet rugged UV-resistant polyethylene. Ergonomics can be felt through the sleek contours of the tank, the integrated lumbar support, and the comfortable shoulder straps. The robust carrying handle makes for easy lifting and also serves as a port where the hand pump can be neatly docked. The large diameter filler neck allows convenient filling, cleaning access, and includes a filler strainer to capture and prevent unwanted particles from entering the hand pump.

The brass hand pump design features a forward grooved hand grip, a robust D-ring for clipping to the shoulder straps, and a rear pistol grip that makes operating the hand pump easier on the wrist and requires less effort than standard hand pumps.

The OT-4NX now features the all-new WATERAX shoulder straps designed to provide users with enhanced comfort and safety. The cushy padded straps provide superior load support and are made with breathable materials for cool and dry operations. They also feature multiple adjustment straps for a custom fit, a chest strap to distribute pressure, heavy-duty fastening clips, and Scotchlite® reflective strips for increased visibility.

- Capacity: 5.3 US gal (20 L)
- Dry weight: 8.5 lbs (2.8 kg)
- Wet weight: 52.6 lbs (23.9 kg)



Capacity: 5 US gal (19 L)
Dry weight: 6 lbs (2.7 kg)
Wet weight: 48 lbs (21.7 kg)

HPO-2X

NEOPRENE BACKPACK WITH BRASS HAND PUMP

The HPO-2X is a rugged collapsible backpack fire pump made of durable nylon fibrecoated with neoprene. The neoprene bag is UV resistant and fireproof. It also offers exceptional abrasion resistance and can easily be repaired in the field with standard tire patches.

BAG:

- Made of nylon fiber coated with neoprene
- Excellent abrasion resistance and in-field repairable
- Fireproof
- Resistant to UV and ozone
- Resistant to oil and gasoline
- Collapsible which requires minimal storage space



Capacity: 5 US gal (19L)
Dry weight: 5.6 lbs (2.5 kg)
Wet weight: 37.6 lbs (17lbs)

VPO-1X

VINYL BACKPACK WITH BRASS HAND PUMP

The new VPO-1X is the latest backpack hand pump to join the WATERAX BACKPAX series. Its collapsible 5 US Gal (19 L) bag is constructed of heavy duty yet lightweight polyester fabric which is encased in vinyl for superior puncture and abrasion protection. Its seams are reinforced in all the right places to eliminate any possibility of leaks. The VPO-1X also features the all-new WATERAX shoulder straps designed to provide users with enhanced comfort and safety. The cushy padded straps provide superior load support and are made with breathable materials for cool and dry operations. They include multiple adjustment straps for a custom fit, a chest strap to distribute pressure, heavy-duty fastening clips, and Scotchlite® reflective strips for increased visibility.

BAG:

- Made of strong polyester fabric encased in vinyl
- Collapsible which requires minimal storage space
- Resistant to UV and ozone
- Removable plastic strainer
- Rugged brass hose connector with brass cap



WATERAX

SHOULDER STRAPS

The all-new WATERAX shoulder straps are designed to provide BACKPAX™ backpack fire pump users with enhanced comfort and safety. The cushy padded straps provide superior load support and are made with breathable materials for cool and dry operations. Multiple adjustment straps allow users of all sizes to customize their fit. The WATERAX shoulder straps also feature a chest strap which takes pressure off the shoulders and distributes it to other muscles in the upper body. This feature eases the tension on the shoulder muscles while retaining the unit in the proper position. Thus, eliminating the backpack pump from slipping off and adversely affecting the user's posture. The WATERAX shoulder straps are secured to the BACKPAX™ water tanks with heavy-duty full swivel clips that allows for easy assembly/removal within seconds. Each individual strap includes a Scotchlite® reflective strip for increased visibility and safety out in the field. The WATERAX shoulder straps can be purchased separately and are completely retrofittable with all previous BACKPAX™ models.

HPC-X

BRASS HAND PUMP

The HPC-X brass hand pump design features a forward grooved hand grip and a rear pistol grip that makes operating the hand pump easier on the wrist and requires less effort than standard hand pumps. It is easy to maintain and is field-repairable. It includes a locking mechanism to prevent drag, extension by gravity, and water loss through drip. The combination tip allows for quick change from spray to straight stream without any tools.

FEATURES AND BENEFITS

- All brass construction
- Sturdy and ergonomic nylon rear pistol grip
- Grooved forward rubber grip
- Dual nozzle: stream/spray
- Field repairable
- Locking feature
- D-ring for clipping to shoulder straps
- Ambidextrous

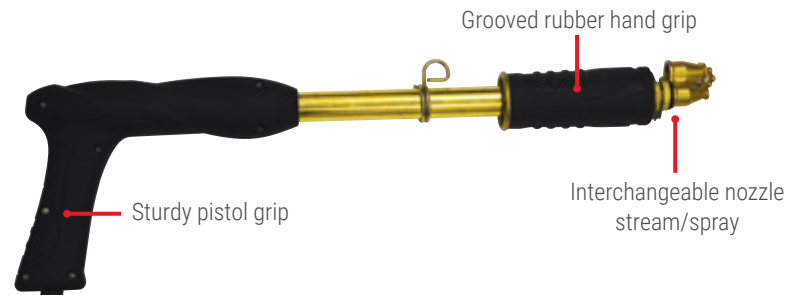

SHOP
NOW

ITEM NO.	DESCRIPTION
250221	OT-4NX POLY BACKPACK WITH BRASS PUMP
250291	VPO-1X VINYL BACKPACK WITH BRASS PUMP
250272	HPO-2X NEOPRENE BACKPACK WITH BRASS PUMP
250251	HPC-X WATERAX HAND PUMP WITH HOSE
600563	HPC-AX WILDFIRE HAND PUMP FOR HPO-2X, BRASS
701483	WATERAX SHOULDER STRAPS WITH CLIPS



DRIPTORCH

WILDFIRE® DRIP TORCH

Powder coated red and made of lightweight aluminum alloy, the Wildfire® drip torch is designed to withstand the rough treatment that drip torches often endure. The safety loop is well away from the flame so there is no danger of the fuel in the loop (liquid seal) vaporizing from heat. The screw type vent valve introduces air to the bottom of the tank to relieve the vacuum created as fuel is being used.

The wick is made of inserted fiberglass. The handle provides good balance in any position.

1.2 US gals (1 imp gal. 4.7 L). 5 lbs (2.3 kg).

NSN 4210-01-558-9951 (NFES 0241).



Item number:
500031



Item number:
700825

OPTION

- 15-030 Truck mount bracket
- Part no. [700825](#)
- This lightweight aluminum Drip Torch Truck Mount Bracket is a two-piece welded assembly. It comes with a thick urethane covered spring strap for securing your Drip Torch in place and has four holes in the bottom plate for mounting to a truck gear box.
- Manufactured to Forest Service Specification 5100-614.
- Meets DOT requirements for transport of flammable liquids

TOOL KIT

A-2388 PUMP TEST KIT

ITEM NO. [250137](#)

For testing WATERAX centrifugal high-pressure fire pump units models: MARK-3®, MINI-STRIKER®, VERSAX®, STRIKER-II®, STRIKER-3 and BB-4® or other pumps requiring evaluation. Can be purchased separately or as a kit consisting of:

ID	NO	DESCRIPTION	QTY
-	250137	A-2388 PUMP TEST KIT	-
1	700555	A-2389 TOOL AND ACCESSORY BOX	1
2	700548	A-2395B CALIBRATED NOZZLE TIP 1/4"	1
3	700546	A-2395D CALIBRATED NOZZLE TIP 3/8"	1
4	600427	C-1933 NOZZLE 1-1/2"NPSH, ALU.	1
5	700545	A-2391 RUBBER HOSE ASSEMBLY 27" LG	1
6	700552	A-2391B ADP, FEM NPT - SWIVEL FEM	1
7	700560	A-2392 PRESSURE GAUGE (DRY) 0-400 PSI	1
8	600061	A-2390 PRESSURE GAUGE ADAPTOR 1-1/2" NPSH	1
9	400022	HOSE SPEC 187 1.5 NPSH X 10" CPLG AL	1



A-2356 TOOL KIT FOR WATERAX PUMP ENDS (12-16S, 18-16S, 25-16S)

ITEM NO. [250125](#)

ID	NO	DESCRIPTION	QTY
-	250125	A-2356 TOOL KIT FOR PUMP END XX-16	-
1	700588	A-5297 SUPPORT TOOL	1
2	600078	A-1887 ALUMINUM GUIDE FOR SHAFT INSTALLATION	1
3	600157*	R-938 PULLER, CRANKSHAFT BEARING 1-PIECE	1
4	600175**	R-904L SPARK PLUG WRENCH C/W ROD	1
5	801305	SUPPORT BUSHING BEARING	1
6	801299	INSTALLER BUSHING BEARING	1
7	600080	A-1890 PRESSING PIN FOR SHAFT REMOVAL, STEEL	1
8	701345	PRESS PIN REMOVAL TOOL PUMP PARTS DIA .686	1
9	600052	B-4084 PUMP BEARING PRESSING SLEEVE	1
10	600077	A-1886 PRESS PIN REMOVAL TOOL PUMP PARTS DIA .925"	1
11	600079	A-1888 PULLER FOR SUCTION COVER, ALU. & PLATED	1
12	700090	A-7644 SEAL PULLER FOR 12-28NS	1
13	700532	A-4097 PROTECTOR SHAFT	1
14	700642	A-7711 SEAL REMOVAL PRESS TOOL, 12-28N	1
15	700531	A-4329 PRESSING SLEEVE ROTARY SEAL	1
16	700540	A-1884 PRESSING SLEEVE DISTRIBUTOR	1



*600157 now replaces [600123](#) (B-4085). **600175 contains [800084](#) (R-904) and [800082](#) (R-905)

R-952N TOOL KIT FOR MARK-3® ENGINE

ITEM NO. [250286](#)

ID	NO	DESCRIPTION	QTY
-	250286	R-952N TOOL KIT FOR MARK-3® ENGINE	-
1	600157	R-938 PULLER, CRANKSHAFT BEARING 1-PIECE	1
2	600164	R-953 CRANKSHAFT JACK	1
3	701352	CIRCLIP REMOVAL TOOL FOR 185CC	1
4	800080	R-928 PROTECTOR CAP, SHAFT 12MM	1
5	700723	R-927 PULLER - MAGNETO (M38 X 1.5)	1
6	600161	R-933 OIL SEAL - PRESSING TOOL	1
7	700707	R-932 PULLER, COLLAR COUPLING	1
8	701343	PISTON RING INSTALLER	1
9	701159	PISTON LOCKING TOOL FOR 185CC	1
10	701349	SEAL INSTALLER 20MM FOR 185CC	1
11	701350	SEAL INSTALLER 25MM FOR 185CC	1
12	701351	CIRCLIP INSTALLER TOOL FOR 185CC	1

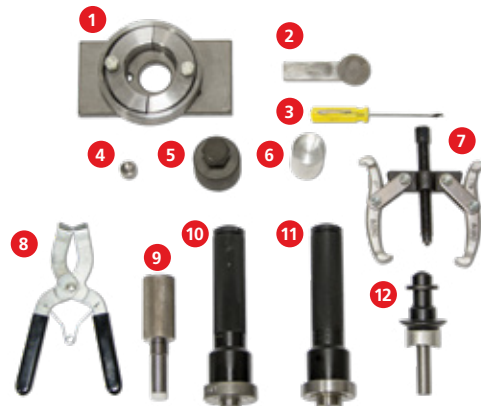

R-900 TOOL KIT FOR MARK-3® PUMP

ITEM NO. [250158](#)

The new MARK-3® comes with a maintenance-free sealed bearing

ID	NO	DESCRIPTION	QTY
-	250158	R-900 TOOL KIT FOR MARK-3® PUMP	-
1	800081	R-908 WRENCH - OPEN END 5 & 8 MM	2
2	700541	A-3023 CARBURETOR ADJUSTING TOOL	1
3	800492	R-902 SCREWDRIVER 1/8" BLADE	1
4	700539	271-928 6 MM T-HANDLE HEX 10.5" LG	1
5	800084	R-904 WRENCH - SPARK PLUG	1
6	800082	R-905 HANDLE - ROD	1
7	700732	R-903 FEELER GAUGE 32 BLADES	1
8	800700	271-346 SCREWDRIVER FLAT 1/4" X 4"	1
9	700538	271-923 WRENCH - ADJUSTABLE 8"	1
10	700726	R-910 WRENCH - OPEN END 1/2" & 9/16"	1
11	600153	R-911M WRENCH, BOX & OPEN END 13 MM	1
12	600160	R-906M WRENCH, BOX & OPEN END 10 MM	1
13	700537	271-488 TOOL ROLL BAG	1
-	700734*	PART-117 GREASE GUN U.S. STYLE	-



*Grease gun no longer included in tool kit. Can be ordered separately.

FUEL TANK ACCESSORIES FOR THE MARK-3®

METAL JERRY CAN

MODEL NO. FA-352GSA-N

Heavy-duty construction throughout, this pick-up portable unit has no petcock or other cumbersome protrusions. Its self-sealing quick coupler enables gasoline line to be changed from one can to another in seconds. 5 US gals (18.9 L). US Forest Service approved. NSN 7240-01-044-5523

Options

12-401B 5' (1.5 m) fuel supply hose with priming bulb and SAE swivel female connectors
R-1206A-GSA 12-401B with B-7527 Male plug with o-rings NSN 4210-00-568-9904



AIR TRANSPORT FUEL TANK

MODEL NO. FA-552Q

Tough, lightweight, and rust proof with its unique and integrated fuel supply adaptor, this container meets the rigid US Military and UN standards (certification #MIL-C-53109). It is the only container to be registered by Transport Canada for UN performance packaging (certification #UN 3H1 / Y1.0/200 / yy / Can / Spr 2 456 / 2.3mm). Seamless all-plastic material, permanently "Olive Drab" colored finish. 5.3 US gals (20 L). Includes inner filter and ball type 1/4-turn fuel supply adaptor **B-7462**.

Approved for air transport via rotary or fixed wing aircraft.

Options

12-401B-NSC 51" (1.3m) fuel supply hose with priming bulb
(Includes **R-712**, **R-732** & **A-7487**)



B-7462
Sold separately

MARINE FUEL TANK

MODEL NO. FA-452 / FA-452-3

The slim design of this marine fuel tank allows storing standing up or lying down. Comes with a standard fuel gauge. UL and CSA standards certification for portable marine fuel tanks. High-density polyethylene, permanently red colored. Capacity of 6.6 US gals (25 L) or 3.2 US gals (12 L).

Options

12-401B-NSC 51" (1.3m) fuel supply hose with priming bulb
(Includes **R-712**, **R-732** & **A-7487**)



Tanks sold separately

ITEM NO.	DESCRIPTION
600376	FA-352GSA-N 5 GAL (19L) JERRY CAN, METAL NSN 7240-01-044-5523
600429	FA-552Q NECT FUEL AIR TRANSPORT TANK WITH QUICK CON
800863	FA-452 MARINE FUEL TANK 6.6 GAL (25L) EPA
800767	FA-452-3 MARINE FUEL TANK 3.2 GAL (12L) EPA
600136	R-1206A-GSA 5' FUEL LINE PRIMING BULB SAE FEM END
600605	12-401B-NSC COMPLETE FUEL LINE, STANDARD STYLE

SHOP
NOW

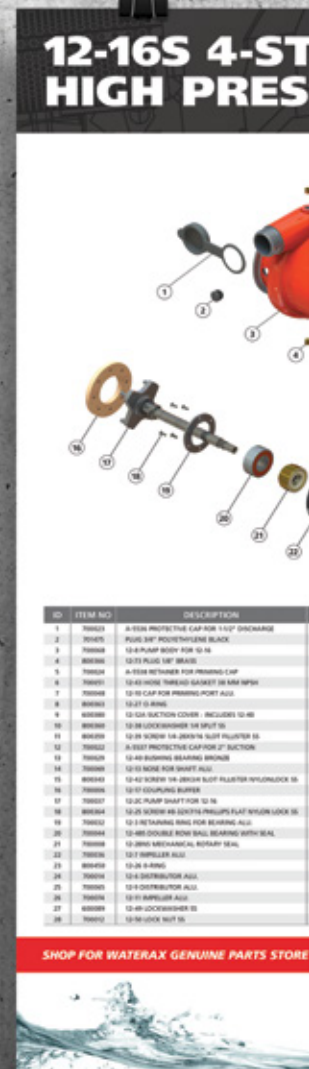
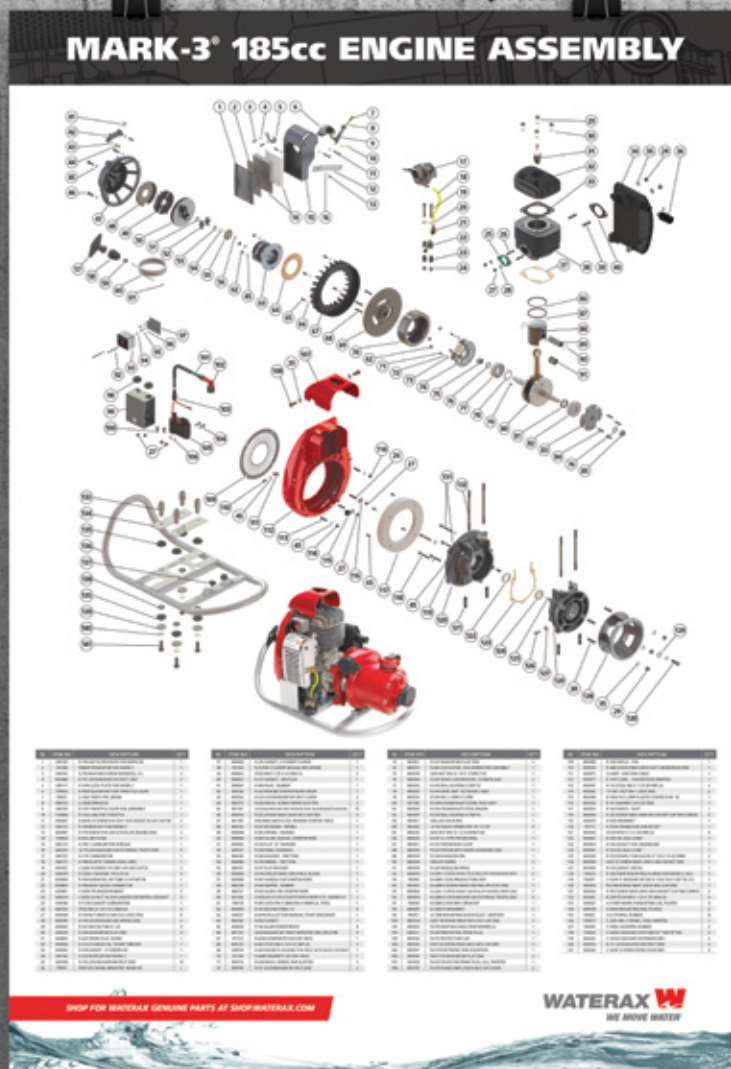

ARE YOU A WATERAX PUMP MECHANIC?

WE NOW HAVE 3 ILLUSTRATED PARTS BREAKDOWN POSTERS AVAILABLE:

- MARK-3® 185cc Engine Assembly
- 12-16S 4-Stage High-Pressure Pump End
- B2X 2-Stage Mid-Range Pump End

ALL WATERAX GENUINE SPARE PARTS ARE AVAILABLE ON THE ONLINE STORE. GET YOUR FREE POSTER WITH YOUR NEXT ONLINE ORDER!



FIRE HOSE

WATERAX offers select forestry fire hose models that are complementary to its fire pump offer. Offered models include Type I weeping and non-weeping filament polyester discharge hose, Type II spun polyester discharge hose (including the renowned Hotline® series), Guardn'flo® synthetic garden hose, and selection of various suction hoses types. Each length of hose is crafted with the wildland firefighter in mind ensuring top quality for optimal performance, light weight for ease of transport and a rugged construction for maximum durability in harsh environments.



APPLICATIONS

- Wildland attack and supply hose
- Mop up hose
- Brush truck attack hose
- Snow making
- Decontamination hose
- Home and cottage protection
- Industrial applications

FEATURES & BENEFITS

- Lightweight and durable
- U.V., mildew, and ozone resistant
- High pressure ratings
- Variety of sizes and threads
- Forged couplings
- Meets or exceeds all performance requirements of NFPA 1961



DRAFTEX® SUCTION HOSE

Lightweight single jacket rigid suction hose, all polyester with helical reinforcement. Durable, flexible and compact. This suction hose will withstand 600 psi (4200 kPa) test pressure and is recommended for tandem operation. Delivered with 2" (51mm) NPSH couplings.



Item number: [400101](#)

ITEM NO.	DESCRIPTION	WEIGHT COUPLED	BURST PRESSURE
400101	2" x 10' (51 mm x 3.1 m) NPSH	5.0 lbs (2.3 kg)	900 PSIG (6300 kPa)

HARD RUBBER SUCTION HOSE

Wire-reinforced suction hose is designed to give high burst strength and maximum service life under almost any condition. Not recommended for tandem operation, nor where heavy equipment will pass over the hose. Available in 2" diameter (51 mm) x 10' length (3.1 m). Delivered with male and female rocker lug aluminum couplings.



Item numbers:
[400178](#) (CAN) - [400392](#) (USA)

PVC SUCTION HOSE

Reinforced lightweight PVC hose useful in situations where equipment weight is critical. Lightweight and flexible, the external helix provides for easy drag. The Clear side wall permits visual check of water flow to ensure that pump is adequately primed. Available in 1.5" (38 mm) and 2" (51 mm) diameters in 10' (3.1 m) lengths.



Item number:
[400200](#) (1.5") - [400195](#) (2")

FIRE HOSE

HOTLINE®

HOTLINE® hose was designed to sustain the high pressure of the MARK-3® pump while enduring rugged environment conditions. It quickly became the most popular and trusted premium layflat forestry hose in North America. Its uncanny abrasion resistance makes it the champion of durability in the field. In fact, it is so resistant that HOTLINE® now has a FIVE YEAR WARRANTY. HOTLINE® also has a high retrieval rate due to its renowned bright florescent yellow appearance, a result of its ENCAP® treatment, and was designed to sustain minimal friction loss. Despite its bright color, it is extremely cleanable after use in even the grittiest of conditions.



Item number: [400010](#)

SHOP
NOW

ITEM NO.	DESCRIPTION
400020	1 X 100 HOTLINE INST ALUM
400007	1 X 100 HOTLINE NPSH ALUM
400019	1.5 X 100 HOTLINE NPSH ALUM
400226	1.5 X 100 HOTLINE NH ALUM
400010	1.5 X 100 HOTLINE INST ALUM

GUARDN'FLO®

Guardn'Flo® is a single-jacket utility hose, available in a 3/4" diameter. It features a polymer coating on the jacket to ensure maximum abrasion resistance and longevity of life while allowing the hose to remain flexible, lightweight and compact for easy storage.

Above all, Guardn'Flo® is versatile and well adapted to a number of different applications:

- Wildfire remote fireline applications
- Forestry mop-up and sprinkler hose kits
- Quick access for brush fires, car fires and decontamination
- Cottage and home protection
- RV potable water delivery
- Home and garden uses: plant and lawn irrigation, washing vehicles
- Agricultural applications



Item number: [400428](#)

SHOP
NOW

ITEM NO.	DESCRIPTION	WEIGHT 100' UNCOUPLED	SERVICE PRESSURE	PROOF PRESSURE	BURST PRESSURE
400428	HOSE GUARDN'FLO 3/4 X 50 W/BRASS GHT COUPLINGS ORANGE	0.85 LBS (1.87 KG)	200 PSI (1380 KPA)	400 PSI (2760 KPA)	600 PSI (4140 KPA)
400431	HOSE GUARDN'FLO 3/4 X 25 W/BRASS GHT COUPLINGS ORANGE	0.43 LBS (0.95 KG)	200 PSI (1380 KPA)	400 PSI (2760 KPA)	600 PSI (4140 KPA)
400430	HOSE GUARDN'FLO 3/4 X 15 W/BRASS GHT COUPLINGS ORANGE	0.26 LBS (0.57 KG)	200 PSI (1380 KPA)	400 PSI (2760 KPA)	600 PSI (4140 KPA)

FIRE HOSE

WX-187-II SYNTHETIC TYPE II FORESTRY HOSE

The WX-187-II is a single jacket spun polyester lay flat hose that is treated for enhanced abrasion and heat resistance. This lightweight hose is designed for wildland firefighting operations where weight is critical. Each length is coupled with quality forged couplings for increased safety and to withstand the rigors of wildland conditions.

Application: Forestry attack hose, brush trucks, structure protection

Jacket: Single jacket high tenacity spun polyester

Lining: Polyurethane

Color: Yellow

Temperature range: -55°C ~ 80°C

Hose standard: Meets or exceeds all performance requirements of NFPA 1961 and is 5100-187c Type II compliant

Coupling type: Forged aluminum

Available size: 1.5" (38 mm)

Standard length: 30 m (100')



Item number: [400499](#)

HOSE SIZE	BOWL SIZE	WEIGHT 100' UNCOUPLED	COIL DIAMETER 100' (30 M)	SERVICE PRESSURE	PROOF PRESSURE	BURST PRESSURE
1.5" (38 mm)	1 11/16" (43 mm)	11.9 lbs (5.4 Kg)	16" (40 cm)	300 PSIG (2100 kPa)	600 PSIG (4140 kPa)	900 PSIG (6300 kPa)



AMERICAN FORESTS

WATERAX TREE PLANTING INITIATIVE

Considering all the wildfires that ravaged landscapes in the past few months, it is necessary to think about restoration of the lands. Planting trees after wildfires is critical to mitigate further damage and establish a new forest for future generations. In partnership with various organizations in Canada and the United States, WATERAX has already donated **10 000 trees** since July 2017 to contribute to forest regeneration after severe wildfires.

FIRE HOSE

WX-187-I SYNTHETIC TYPE I FORESTRY LAY FLAT HOSE

The WX-187-I is a remarkably lightweight synthetic forestry lay flat hose. It is made of 100% filament polyester and is lined with TPU elastomer. This tough yet lightweight hose is designed for wildland firefighting operations where weight is critical. Each length is coupled with quality forged couplings for increased safety and to withstand the rigors of wildland conditions.

Application: Forestry attack hose, industrial applications, brush trucks, structure protection

Jacket: Single jacket 100% virgin high tenacity polyester

Lining: Polyurethane

Color: White

Temperature range: -55°C ~ 80°C

Coupling type: Forged aluminum

Hose standards: Meets or exceeds all performance requirements of NFPA 1961 and is 5100-187c Type I compliant

Available sizes: 1" (25 mm), 1.5" (38 mm)

Standard length: 30 m (100')



Item number: [400496](#)

HOSE SIZE	BOWL SIZE	WEIGHT 100' UNCOUPLED	COIL DIAMETER 100' (30 M)	SERVICE PRESSURE	PROOF PRESSURE	BURST PRESSURE
1" (25 mm)	1 5/32" (29 mm)	5.67 lbs (2.58 Kg)	15" (37 cm)	300 PSIG (2100 kPa)	600 PSIG (4140 kPa)	900 PSIG (6300 kPa)
1.5" (38 mm)	1 11/16" (43 mm)	11.9 lbs (5.4 Kg)	16" (40 cm)	300 PSIG (2100 kPa)	600 PSIG (4140 kPa)	900 PSIG (6300 kPa)

SHOP NOW

ITEM NO.	DESCRIPTION
400496	1.5 X 100 WX-187-I TYPE I INST ALUM
400497	HOSE 1.5 X 50 WX-187-I TYPE I INST ALUM
400500	HOSE 1 X 100 WX-187-I TYPE I INST ALUM



WATERAX IS 100% FOCUSED
ON THE REAL NEEDS OF WILDLAND FIREFIGHTING
—FOR TODAY AND TOMORROW.

WX-187-IWP SYNTHETIC TYPE I WEEPING FORESTRY HOSE

The WX-187-IWP is a single jacket filament polyester lay flat hose that weeps for self-protection. This tough yet lightweight hose is designed for wildland firefighting operations where weight is critical. Each length is coupled with quality forged couplings for increased safety and to withstand the rigors of wildland conditions.

Application: Forestry attack hose, brush trucks, structure protection

Jacket: Single jacket 100% virgin high tenacity polyester

Lining: Polyurethane

Color: White

Temperature range: -55°C ~ 80°C

Hose standard: Meets or exceeds all performance requirements of NFPA 1961 and is 5100-187c Type I compliant

Coupling type: Forged aluminum

Available sizes: 1" (25 mm), 1.5" (38 mm)

Standard length: 30 m (100')



Item number: [400498](#)

HOSE SIZE	BOWL SIZE	WEIGHT 100' UNCOUPLED	COIL DIAMETER 100' (30 M)	SERVICE PRESSURE	PROOF PRESSURE	BURST PRESSURE
1" (25 mm)	1 5/32" (29 mm)	5.67 lbs (2.58 Kg)	15" (37 cm)	300 PSIG (2100 kPa)	600 PSIG (4140 kPa)	900 PSIG (6300 kPa)
1.5" (38 mm)	1 11/16" (43 mm)	11.9 lbs (5.4 Kg)	16" (40 cm)	300 PSIG (2100 kPa)	600 PSIG (4140 kPa)	900 PSIG (6300 kPa)

**SHOP
NOW**

ITEM NO.	DESCRIPTION
400510	1 X 100 WX-187-IWP TYPE I WEEPING INST ALUM
400498	1.5 X 100 WX-187-IWP TYPE I WEEPING INST ALUM
400501	1.5 X 50 WX-187-IWP TYPE I WEEPING INST ALUM



**BUILT ON 100 YEARS OF INNOVATION,
WATERAX IS PROUD TO CONTINUE DESIGNING, MANUFACTURING
AND SUPPORTING HIGH-PERFORMANCE AND DURABLE PORTABLE PUMPS.**

WATER HANDLING ACCESSORIES

WATERAX provides hardware solutions that are an integral part of water handling systems. Our hardware categories include nozzles, shut-off valves, wye valves, sprinkler kits, inline accessories, couplings, and adaptors. Our hardware solutions are an essential part of the serious firefighter's arsenal and form the backbone of superior water handling systems.

NOZZLES

WATERAX offers a selection of fire hose nozzles that are an essential part of a complete pump kit. These nozzles are built to withstand the impressive flows and pressures generated by WATERAX pumps. A variety of nozzles are offered to accommodate multiple water handling applications.



MK-177 ALUMINUM NOZZLE

Lightweight, corrosion resistant and durable nozzle, features combination tips and rubber gaskets. Flame resistant, it is designed to withstand 600 psi (4136 kPa) test pressure. Anodized aluminum alloy to minimize thread seizures. 9" (23 cm) long.



Item number: [250163](#)

UNI-1550 NOZZLE COMBINATION TIPS - JET STREAM

Lightweight, corrosion resistant and durable nozzle, comes with combination tips and rubber gaskets. This polycarbonate nozzle is smooth bored for a more effective and uniform water stream. Flame resistant and rib-reinforced for strength and gripping. 9" (23 cm) long. 1 1/2" (38 mm) female NPSH inlet, 5 oz (142 g). Rated at 100 PSI (689 kPa)



Item numbers: [300488](#)

NOZZLE COMBINATION SPRAY/STRAIGHT STREAM

1 1/2" (38 mm) female NPSH inlet, 8 oz (226 g). Lightweight, corrosion resistant and durable nozzle. Polycarbonate, flame resistant and rib-reinforced for strength and gripping. Supplied with 1 1/2" (38mm) rubber gasket (12-43). 5 1/2" (14 cm) long.



Item number: [300486](#)

ITEM NO.	MODEL	DESCRIPTION	FLOW AT 100 PSI (689 KPA)
300486	UNI-1030-1	1" (25 mm) female NPSH inlet, 8 oz (226 g)	22 US GPM (83 LPM)
300489	UNI-1030-75	3/4" (19 mm) female GHT inlet, 7 oz (198 g)	8 US GPM (30 LPM)
300482	UNI-1575	1 1/2" (38 mm) female NPSH inlet 8 oz (226 g)	75 US GPM (283 LPM)

PAM-FBN MULTI-APERTURE NOZZLE

This durable nozzle is designed to withstand the high pressure requirements of forestry applications. The diamond knurl grip provides easy adjustments. Four spray sizes available: 1/8", 3/16", 1/4", 5/16" (3, 5, 6, 8 mm). The nozzle couples to all 1 1/2" quarter-turn couplings. Rated at 600 PSI (4136 kPa).



Item number: [301004](#)

FA-407 3/4" GHT VARIABLE FLOW NOZZLE

Light, compact, corrosion resistant solid brass with stainless steel construction. Eliminates changing nozzle tips. Designed for 3/4" (19 mm) garden hose thread GHT couplings, it can produce solid stream, spray, mist or shut-off by simply turning the nozzle's tips. Built-in nozzle gasket for trouble-free use 3 oz (80 g). Rated at 600 PSI (4136 kPa)



Item number: [301034](#)

WATER HANDLING ACCESSORIES

FEATHER-LITE™ NOZZLES

Provides a continuously adjustable water stream from shut-off to straight stream to full fog pattern. The Feather-Lite™ base, threads and body are hard anodized for increased longevity. GPM flow rates are stamped on each nozzle. Nozzles weight 10 oz (284 g) or less.



Item number: [300497](#)

ITEM NO.	GALLONAGE	SIZE	THREAD
300497	6-14 US gals/min low pressure (23-53 L/min)	3/4" (19 mm)	GHT
302431		1" (25 mm)	NPSH
250079	10-24 US gals/min (38-91 L/min)	1" (25 mm)	NH
300501		1" (25 mm)	NPSH
300505		1" (25 mm)	NH
250072	10-24 US gals/min (38-91 L/min), RANGER (Without bumper) NFES # 1081	3/4" (19 mm)	GHT
300493		1" (25 mm)	NPSH
250096	10-40 US gals/min (38-151 L/min)	1" (25 mm)	NH
250092	20-60 US gals/min (76-227 L/min), NFES # 1082	1 1/2" (38 mm)	NH
300490	20-60 US gals/min (76-227 L/min)	1 1/2" (38 mm)	NPSH
250048	20-95 US gals/min (76-360 L/min)	1 1/2" (38 mm)	NH

FEATHER-LITE™ SMOOTH BORE TIPS

The ultimate nozzles for high penetrations with low nozzle reaction force at all pressures. Small orifices are sized for traditional wildland application rates. Tips are hard anodized and marked in accordance with US Forest Service specifications.



Item number: [250095](#)

ITEM NO.	GALLONAGE	SIZE	THREAD
250009	1/4" (6.4 mm)	1" (25 mm)	NPSH
250010	3/8" (9.5 mm)	1" (25 mm)	NH
250095	3/8" (9.5 mm)	1 1/2" (38 mm)	NH
250105	3/8" (9.5 mm)	1" (25 mm)	NPSH
600484	3/8" (9.5 mm)	3/4" (19 mm)	GHT
600476	3/16" (4.8 mm)	3/4" (19 mm)	GHT

TWIN TIP NOZZLES

Lightweight aluminum nozzles equipped with a three position valve to provide instant selection of straight stream, fog stream, or shut-off. The nozzles have a 3/4" (19 mm) or a 1" (25 mm) female inlet and two 3/4" (19 mm) male GHT parallel outlets. Each nozzle includes a standard straight stream tip available in three bore sizes and choice of secondary tip: Fog stream available in three flow options or foam nozzle available in two flow options. Weighs 1.2 lbs (0.5 kg). Complies with US Forest Service Spec 5100-240.



Item number: [250046](#)

FOG-STREAM

ITEM NO.	GALLONAGE	SIZE	THREAD	BORE SIZE
250047	18° fog pattern at 3 US gals/min (11 L/min)	3/4" (19 mm)	GHT	3/16" (4.8 mm)
250046		1" (25 mm)	NPSH	3/16" (4.8 mm)
250054	18° fog pattern at 6 US gals/min (23 L/min)	3/4" (19 mm)	GHT	3/8" (9.5 mm)

FOG STREAM REPLACEMENT TIPS

Item No.	Gallonage
700468	18° pattern at 3 US gals/min (11 L/min), NFES # 0635
700469	18° pattern at 6 US gals/min (23 L/min), NFES # 0636
700470	18° pattern at 15 US gals/min (57 L/min)



STRAIGHT STREAM REPLACEMENT TIPS

Item No.	Gallonage
600484	3/8" bore (9.5 mm) - 42 US gals/min (159 L/min), NFES # 0638
600476	3/16" bore (4.8 mm) - 10 US gals/min (38 L/min), NFES # 0637



WATER HANDLING ACCESSORIES

SPOT AND MOP NOZZLES

Designed for initial attack in flash fuels, structure protection, and to combat small wildland fires. These nozzles are the best mop-up tools in the business. They have enough reach to pretreat a two-story house and surrounding area in a short amount of time. Delivers 0.5% Class A foam concentrate at 10 to 14 times expansion (varies according to water and foam used). Made of high strength aircraft aluminum. Weighs 7 oz (199 g).



Item number: [250099](#)

ITEM NO.	GALLONAGE	SIZE	THREAD
250100	10 US gals/min (38 L/min)	1" (25 mm)	NH
250101		1" (25 mm)	NPSH
250102		3/4" (19 mm)	GHT
250099	18 US gals/min (68 L/min)	1" (25 mm)	NH
250106		1" (25 mm)	NPSH
250107		3/4" (19 mm)	GHT
250108	40 US gals/min (151 L/min)	1 1/2" (38 mm)	NH

VALVES, WYES, WATER THIEVES

A selection of inline hardware used for protecting, shutting off, splitting, and dividing hose lines which is required for various water handling techniques such as parallel pumping, progressive hose lays, sprinkler operations, backpack pump refilling, etc.



FEATHER-LITE™ BALL SHUT-OFF VALVES

Strong and lightweight positive shut-off valves. They feature a large horseshoe handle that is comfortable with or without gloves, a dual drive co-polymer valve ball, and dual handle stops. They also feature externally adjustable valve seats. The full waterway is perfectly aligned to reduce friction and enhance compressed air foam. Valves operate freely to 600 psi (4200 kPa) and are tested to 1200 psi (8300 kPa). The shut-off valves weight 20 oz (567 g) or less.



Item number: [250024](#)

ITEM NO.	SIZE	THREAD	PISTOL GRIP
250024	1" (25 mm)	NH	No
250067	1" (25 mm)	NH	Yes
250066	1 1/2" (38 mm)	NPSH	No
300504	1 1/2" (38 mm)	NPSH	Yes

PISTOL GRIP BALL SHUT-OFF 1.5" (38MM)

The 4080 Pistol Grip Shut-Off features with finger grooved hand grips for superior comfort. Connects to 1-½" fire hose, or with a 4082/4083 reducer, a 1" hose line. Available with NPSH thread. Manufactured from tough, corrosion-free, glass-reinforced polymer. Includes a right and left side and stainless steel fasteners.



Item numbers: [301072](#)

GARDEN HOSE SHUT-OFF VALVE, 3/4" (19 MM)

The SPE-0803790 is a brass ball type shut-off valve that is used with small hoses and nozzles. It can withstand 600 PSI for 3 minutes without leakage or damage and is manufactured per US Forest Service spec 5100-190. It has a 3/4" (19 mm) female inlet to 3/4" (19 mm) male GHT outlet.

NSN 4210-01-412-5684 (NFES 0835)



Item numbers: [301791](#)

GATED WYE BALL VALVE, 2 1/2" (64 MM) NH

Designed to withstand 600 PSI (4136 kPa), with unrestricted flow. Balls adjust automatically to compensate for wear. Light, corrosion resistant anodized alloy, painted bright red. Supplied with gasket. One hard anodized ball bearing rocker lug swivel hose fitting 2 1/2" (64 mm) female inlet NH and two 1 1/2" (38 mm) male NPSH outlets. 4 lbs (1,8 kg).



Item number: [300498](#)

PLAIN WYE BALL VALVE, 2 1/2" (64 MM) NH

Wye valve reducer with a 2 1/2" (64 mm) NH inlet and two 2" (51 mm) NPSH outlets. It is often used with the WATERAX B2 and B2X pump ends in order to reduce the suction inlet from 2 1/2" (64 mm) NH to two 2" (51 mm) NPSH suction inlets. By adding this reducer, users are able to utilize their existing 2" (51 mm) suction lines instead of purchasing or having to carry additional 2 1/2" (64 mm) suction lines.



Item number: [300998](#)

GATED WYE BALL VALVE, 1 1/2" (38 MM) NPSH

The WFE-24525252 features a rocker lug swivel 1 1/2" (38 mm) female NPSH inlet and 1 1/2" (38 mm) male NPSH outlets. Operates freely at 600 PSI (4136 kPa). Balls adjust automatically to compensate for wear. Lightweight Aluminum body with cast aluminum handles. Meets US Forest Service spec 5100-380 and made in the USA. 3.4 lbs (1,5 kg).



Item number: [300506](#)

WATER HANDLING ACCESSORIES

GATED WYE BALL VALVE, 1/4-TURN

The WFE-24525252QT is designed for 1 into 2 or 2 into 1 operation and to withstand 600 PSI (4136 kPa). Unrestricted flow. Balls adjust automatically to compensate for wear. Light, corrosion resistant anodized alloy, optional painted bright red. Three 1 1/2" (38 mm) NPSH openings with three 1/4-turn adaptors. Meets US Forest Service spec 5100-380 and made in the USA. 3.75 lbs (1.7 kg).



Item number: [300495](#)

PLAIN WYE BALL VALVE, 1/4-TURN

The SA-25 is designed for 1 into 2 or 2 into 1 operation and to withstand 600 PSI (4136 kPa). Unrestricted flow. Light, corrosion resistant anodized alloy, painted bright red. 1 1/2" (38 mm) wye equipped with three 1/4-turn connections. 1 1/2 lbs (680 g).



Item number: [250127](#)

BRASS DIVIDING BALL VALVE, 3/4" (19 MM) GHT

Brass dividing ball valve wye, used with garden hose and sprinkler systems, has a 3/4" (19 mm) female GHT inlet and two 3/4" (19 mm) male GHT outlets. It can withstand 600 PSI for 3 minutes without leakage or damage and is manufactured per US Forest Service spec 5100-190.

NSN 4210-01-412-6335 (NFES 0904)



Item number: [301689](#)

3-WAY VALVE, 1 1/2" (38 MM) NPSH

Light weight water distribution device with durable construction made of Ny-Glass. Features a built in "weep" feature to help prevent silt blockage. Includes three 1 1/2" (38 mm) NPSH male outlets. New handle shape accepts storz adapters. Rated for 300 PSI (2068 kPa) safe working pressure.



Item number: [300971](#)



SPOT AND MOP NOZZLES

A select number of adapters and fittings that are used with WATERAX pump kits and applications.

ADAPTER - FEMALE BY 1/4-TURN

ITEM NO.	MODEL	DESCRIPTION
250183	FA-4	1 1/2" (38 mm) NPSH x 1/4-turn adaptor
300879	FA-4N	1 1/2" (38 mm) NPSH x 1/4-turn adaptor, meets ULC specification
250190	FA-28	3/4" (19 mm) GHT x 1/4-turn adaptor
250187	FA-6	1" (25 mm) NPSH x 1/4-turn adaptor
300634	ADP-A-QTF10N	1" (25 mm) NH x 1/4-turn adaptor
300648	ADP-A-QTF15N	1 1/2" (38 mm) NH x 1/4-turn adaptor



Item number: [250183](#)

ADAPTER - MALE BY 1/4-TURN

ITEM NO.	MODEL	DESCRIPTION
250181	FA-3	1 1/2" (38 mm) NPSH x 1/4-turn adaptor
300883	FA-3N	1 1/2" (38 mm) NPSH x 1/4-turn adaptor, meets ULC specification
250180	FA-27	3/4" (19 mm) GHT x 1/4-turn adaptor
250169	FA-5	1" (25 mm) NPSH x 1/4-turn adaptor
300646	ADP-A-QTM10N	1" (25 mm) NH x 1/4-turn adaptor
300645	ADP-A-QTM15N	1 1/2" (38 mm) NH x 1/4-turn adaptor



Item number: [250181](#)

COUPLING SETS - 1/4-TURN

Coupling set made of light corrosion resistant anodized aluminum alloy. Supplied with gasket, hose bowl gasket and expansion ring.

ITEM NO.	MODEL	DESCRIPTION
250186	FA-7	1 1/2" (38 mm) 1/4-turn coupling set, includes gaskets and expansion rings
300886	FA-7N	1 1/2" (38 mm) Forged 1/4-turn coupling set ULC approved, includes gaskets and expansion rings
250184	FA-8	1" (25 mm) 1/4-turn coupling set, includes gaskets and expansion rings



Item number: [250186](#)

WATER HANDLING ACCESSORIES

ALUMINUM 1/4-TURN CAP

FA-13 1/4-turn blanking cap with gasket



Item number: [600447](#)

1/4-TURN TANDEM ADAPTERS

A-6888: 2" (51 mm) NPSH x 1/4-turn, Aluminum

A-6888N: 2" (51 mm) NPSH x 1/4-turn ULC, forged aluminum



Item numbers:
[250170](#), [250133](#)

REDUCER - FEMALE BY MALE

ITEM NO.	MODEL	DESCRIPTION
300594	ADP-A-FM10S75G	1" NPSH x 3/4" GHT (25 mm x 19 mm)
301493	ADP-A-FM15N75G	1 1/2" NH x 3/4" GHT (38 mm x 19 mm)
300580	ADP-A-FM15S75G	1 1/2" NPSH x 3/4" GHT (38 mm x 19 mm)
300703	ADP-A-FM15N10S	1 1/2" NH x 1" NPSH (38 mm x 25 mm)
300632	ADP-A-FM20S15N	2" NPSH x 1 1/2" NH (51 mm x 38 mm)
300631	ADP-A-FM25N15N	2 1/2" NH x 1 1/2" NH (64 mm x 38 mm)



Item number: [300631](#)

ADAPTER - FEMALE BY MALE

ITEM NO.	MODEL	DESCRIPTION
300676	ADP-A-FM10NS	1" NH x 1" NPSH (25 mm x 25 mm)
300593	ADP-A-FM10SN	1" NPSH x 1" NH (25 mm x 25 mm)
300573	ADP-A-FM15NS	1 1/2" NH x 1 1/2" NPSH (38 mm x 38 mm)
300579	ADP-A-FM15SN	1 1/2" NPSH x 1 1/2" NH (38 mm x 38 mm)



Item number: [300676](#)

PUMP THREAD PROTECTORS

A-2688: 2" (51 mm) female rigid NPSH x 2" (51 mm) male NPSH, aluminum

ADP-A-FM15S: 1.5" (38 mm) female rigid NPSH x 1.5" (38 mm) male NPSH, aluminum



Item numbers:
[300846](#), [300602](#)

B2X ADAPTER KITS

ADP-B2X-30N25N: Adapter kit for B2X pump which includes a double male 3" (76 mm) NPT x 3" (76 mm) NH aluminum adapter for the suction and a double male 2.5" (64 mm) NPT x 2.5" (64 mm) NH aluminum adapter for the discharge.

ADP-B2X-25N25N: Adapter kit for B2X pump which includes a double male 3" (76 mm) NPT x 2.5" (64 mm) NH aluminum adapter for the suction and a double male 2.5" (64 mm) NPT x 2.5" (64 mm) NH aluminum adapter for the discharge.



Item numbers:
[250231](#), [250245](#)

GASKETS

ITEM NO.	NAME	TYPE	HOSE SIZE	THREAD
700702	FA-12	Neoprene groove gasket	1 1/2" (38 mm)	1/4-turn
301644	GSK-SW-15S	Swivel face gasket	1" (25 mm)	NH
300866	GSK-SW-15S		1 1/2" (38 mm)	NPSH
300877	GSK-SW-15N		1 1/2" (38 mm)	NH
300875	GSK-SW-20S		2" (51 mm)	NPSH



Item number: [700702](#)

BRASS EXPANSION RINGS

ITEM NO.	MODEL	DESCRIPTION
300822	EXP-1X1	1" (25,4 mm) 1" (25,4 mm)
300747	EXP-15X875	1 1/2" (38,1 mm) 7/8" (22,2 mm)
300745	EXP-15X1	1 1/2" (38,1 mm) 1" (25,4 mm)
300746	EXP-15X125	1 1/2" (38,1 mm) 1 1/4" (31,8 mm)



Item number: [300747](#)

WATER HANDLING ACCESSORIES

FOOTVALVE AND STRAINER 2" (51 MM)

Spring-loaded check valve, capable of holding a water head equal to 300 PSI. Designed with an ear hole for ease of tying to a floatation device in order to prevent suction of debris. Specifically made for use with the MARK-3®, BB-4®, STRIKER II-PLUS®, ULTRA-STRIKER® and any other pumps using a 2" (51mm) NPSH.

ITEM NO.	DESCRIPTION
250288	Footvalve and Strainer 1 1/2" (38 mm) NPSH, Aluminum
301753	Footvalve and Strainer 1 1/2" (38 mm) NH, Aluminum
302469	Footvalve and Strainer 1 1/2" (38 mm) NPT, Brass
250151	Footvalve and Strainer 2" (51 mm) NPSH, Aluminum
300967	Footvalve and Strainer 2 1/2" (63 mm) NH, Aluminum
301755	Footvalve and Strainer 3" (76 mm) NH, Aluminum



Item numbers: [250151](#)

A-6935 BALL CHECK VALVE

Installed on the discharge side of the pump, the internal rubber ball instantaneously prevents water return when the pump stops. Very useful in uphill pumping to prevent possible damage to the pump from return pressures. This light corrosion resistant alloy valve has a brass pressure relief pin and two 1 1/2" (38 mm) 1/4-turn connections.



Item number: [250134](#)

B-6365 AUTOMATIC CHECK VALVE NPSH

The automatic check valve prevents pressure return. 1 1/2" (38 mm) female NPSH to 1 1/2" (38 mm) male NH with 1" (25 mm) female NPT bypass. Made with lightweight, anodized aluminum material.



Item number: [600428](#)

CHECK & BLEEDER VALVE

The Automatic Check and Bleeder Valve is designed to retain water in fire hose lines when the pump is temporarily turned off, preventing loss of pump prime when used with centrifugal pumps in wildland firefighting activities. The pump can be restarted without the pressure of the head of water in the hose by bleeding through the bleeder valve.

Our lightweight aluminum alloy valves are hard anodized according to military specification and consists of only ten easily-serviceable components. The valve includes a 1-1/2" 9 NH internal threaded inlet, a 1-1/2" 9 NH external threaded outlet and a 1" 11-1/2 NPSH external threaded bleeder outlet. Meets Forest Service Spec. 5100-382c



Item number: [302424](#)

WATER THIEVES

Designed for insertion at various points along 1 1/2" (38 mm) hose line for filling backpack tanks, water bags, protecting hose line, connecting to sprinklers, etc. Supplied with 3' (0.9 m) of 1/2" (12.7 mm) garden hose, clamps, nozzle tip, and 1 1/2" (38 mm) rubber gaskets.

ITEM NO.	MODEL	DESCRIPTION
600402	A-6471	1 1/2" (38 mm) NPSH with 3/4" (19 mm) GHT connection.
250159	OT-25	A-6471 with 1/2" (12.7 mm) hose and nozzle tip.
600370	A-6046	1/4-turn with 3/4" (19 mm) GHT connection.
250123	A-6046N	Forged 1/4-turn with 3/4" (19 mm) GHT connection.
250154	OT-27	A-6046 with 1/2" (12.7 mm) hose and nozzle tip.
300974	SCO-4040SO	Plastic water thief, 1 1/2" (38 mm) male NPSH with 3/4" (19 mm) GHT connection.



Item number: [600402](#)

SPRINKLER KIT

The B-6545K sprinkler kit is made with corrosion resistant material. Its head (11" long) is mounted on a bearing, fitted with 3/4" (19 mm) female GHT swivel coupling, and an A-6046 1/4-turn with 3/4" (19 mm) GHT connection. Spike length: 11" and the kit includes B-6545 Sprinkler, A-6046 water thief and 3/4" x 25' of Guardn'Flo® hose.



Item number: [250129](#)

GUARDN'FLO® KIT

KIT-6-7250 includes a belt pouch, Guardn'Flo® 3/4" (19mm) x 50' (15 m) hose coupled GHT and brass variable flow nozzle

FA-407. Packed dimensions: 7 1/2" x 2" x 9 1/2" (19 x 5 x 24 cm); 20 oz (567 g).



Item number: [400047](#)

WATER HANDLING ACCESSORIES

RAPID DEPLOYING HOSE BAG

The WHT-BGHOPUM is made of durable 18 oz PVC coated textile, it is designed to easily and quickly deploy five lengths of 100' (30.5 m) pre-coupled 1 1/2" (38 mm) hose wound in figure 8 patterns. The hose is dispensed so that it lays flat allowing for quick hassle free pressure up of the hose. Simply open up the hose port flap, put on the pack and walk out the hose!



Item number: [500150](#)

UNIVERSAL HOSE WRENCH

The B-2066 is used for coupling and uncoupling 1" (25 mm), 1 1/2" (38 mm), 2" (51 mm) hose line couplings, swivel hose fittings, pin or rocker lug couplings. Light, corrosion resistant anodized alloy. 7" (180 mm). 4 1/2 oz (128 g).



Item number: [250124](#)

SPANNER WRENCH

Single-ended coupling-type wrench fits 1" (25 mm) and 1 1/2" (38 mm) NPSH, and 1 1/2" (38 mm) NH couplings. Designed for use on slotted or rocker-lug couplings on fire hoses. Made of lightweight aluminum. Meets US Forest Service Spec 5100-101.

NSN 5120-00-596-1426 (NFES 0234)

BER-7-4030 Double-ended wrench fits 1" (25 mm) and 1 1/2" (38 mm) NPSH, 1 1/2" (38 mm) NH, and 2 1/2" (64 mm) NH couplings.

NSN 5120-00-596-1427 (NFES 0235)



Item number: [250327](#)



Item number: [300984](#)

FORESTRY HOSE WINDER

SCO-4100 Simple and effective device for the recovery of 50' (15 m) of either 5/8" or 3/4" (16 or 19 mm) Econoflo hose. It strips off mud, squeezes out water and quickly rolls the hose in a neat compact roll.



Item number: [301081](#)

ALUMINUM HAND PRIMER B-5980

A quick and easy way to prime a pump with 2" x 10' (51 mm x 3.1 m) suction hose and 8' (2.4 m) lift in less than 20 seconds. Particularly useful and effective if pump is used to draw water from well, tank, etc. 1 1/2" (38 mm) female NPSH or NH (brass insert).

Length: 12 1/2" (31.7 cm). 2 1/2 lbs (1.1 kg).



Item numbers:
[250144](#), [250219](#)

STRAIGHT HOSE CLAMP

The shut-off hose clamp is designed to temporarily shut off the flow of water (up to 300 psi water pressure) to prevent loss of water when a fire hose bursts, or for other purposes - such as rapid changing of nozzles, hoses, etc. Made of heat-treated cast aluminum, brass, and stainless steel, this hand tool is lightweight and compact enough to easily carry in a pocket.

Our clamp is designed specifically for use on 1" and 1-1/2" single-jacket, cotton-synthetic fire hoses qualified under USDA Forest Service Specification 5100-186 (Type 186). Use on other hoses may result in slippage or clamp failure under normal operating conditions.

NSN 4210-00-767-7123. NFES 0046. Meets Forest Service Spec 5100-245



STRANGLER®, V-SHAPED HOSE CLAMP

Specifically designed for thin walled synthetic hoses, the B-5420 has two positions or settings for different hose wall thickness 1/4" or 1/8" (6 or 3 mm). Replaceable rubber shoe prevents damage to hose. Light, corrosion resistant alloy. 11 1/2" (29 cm) long. 1.5 lbs (682 g). Can be carried in belt pouch FA-149. The B-5420 models have two "settings" that are designed to accommodate hose strangling for hoses of different thickness (single-jacket, double-jacket, etc...). One setting "squeezes tighter" than the other.

Options: [250140](#): B-5420P Hose clamp painted red. [700696](#): FA-149 Standard pouch for B-5420. [700563](#): A-5415R Rubber shoe.



Item number: [250139](#)

MINI BASIN

The Mini Basin is designed for the secondary containment of hazardous materials from fuel and oil spills that occur when operating engine driven, gasoline and diesel powered equipment. It easily collapses for maximum portability and was designed to fit in the MARK-3® kit assembled at numerous fire caches. Strengthening rods, reinforced corners and grommets are provided to add stability and offer a tie-down option.

Construction: 22 oz red vinyl.

Dimensions (deployed): 32" x 32" x 4" (81 x 81 x 10 cm)
(collapsed): 4 1/2" X 1 1/2" X 32" (10.5 x 3.8 x 81 cm)



Item number: [300393](#)

MARK-3® PUMP CARRYING PACK

The C-7404 is a carrying pack designed to transport the MARK-3® fire pump. It features adjustable nylon straps and also serves as an effective resting surface for operating the pump on the terrain.



Item number: [250117](#)



WATERAX ONLINE STORE

**Don't get caught
with your pumps
down!**

Visit the exclusive WATERAX online store. Order all of your WATERAX genuine parts here.

Purchase exclusive genuine spare parts for multi-stage high-pressure centrifugal pumps.

VISIT OUR WEBSITE
© [SHOP.WATERAX.CA](https://shop.waterax.ca)

WATERAX 
WE MOVE WATER

ACTIVATE YOUR ACCOUNT

By registering you will be able to place orders online, have access to your net pricing and discounts, create quotes, estimate shipping rates,

view the status of past and current orders, get access to the latest product catalogs and view your latest statements.



WATERAX PARTS CATALOG

This catalog is now available online and features expanded views of all our pumps and pump ends. The catalog is interactive and connected to

our NEW online store, you can now show within the pages of your catalog and checkout on shop.waterax.com.



WATERAX TECHNOLOGY CENTER

Join the community for WATERAX Pump Mechanics! Log in to the WATERAX technology center to access step-by-step mechanic guidebooks, detailed

how-to videos, tools and relevant parts. You can also post comments and ask questions directly on the platform to get answers from our engineering team.



WATERAX LIMITED WARRANTY

WHEREAS subject to the following general and specific terms and conditions, WATERAX Inc. (the "Seller") hereby warrants (the "Purchaser") that its products, including any pump parts products manufactured by WATERAX (the "Products") sold under WATERAX Inc. brands will be free of defects in material and workmanship for the applicable Warranty Period (as set out at section 2); The general terms and conditions applicable for all Products are set forth under section 1. the specific terms and conditions applicable for all Products, including Warranty Periods and Warranty Coverage, are set forth in the table under section 2;

General terms and conditions

The following limitations, exclusions, procedures and other terms and conditions shall apply for all Products:

1. The Warranty shall be voided upon the occurrence of any of the following events:

- a. The Product is used for an application, with products or in a manner other than the application, products and manner for which such Product is designed and intended;
- b. The Product is subjected to a use, service, condition or environment other than a use, service, condition or environment for which such Product is designed and intended;
- c. The Product is not properly installed by the Purchaser or its agent or representative;
- d. The Product is not properly tested and maintained in accordance with Seller's product manuals and supplemental instructions and guidelines as set out in full at www.waterax.com/eng/warranty, applicable industry standards and guidelines, and applicable legal and regulatory requirements;
- e. The Product is altered, modified, serviced (with the exception of routine maintenance performed in accordance with the Seller's product manuals and supplemental instructions, and industry accepted standards and guidelines), or repaired by a person other than the Seller or a person authorized by the Seller to make such alteration or modification or perform such service or repair;
- f. The Seller is not paid the full amount of the purchase price for the Product when due;
- g. Any bad faith invocation of a warranty claim or breach of a purchase agreement by the Purchaser.

2. The following are excluded from Warranty coverage:

- a. Non-defective parts worn, exhausted or consumed through normal usage of the Product;
- b. Any consumable parts normally subject to routine replacement, including but not limited to pump packing, O-rings, gaskets, intake screens, anodes or filters;
- c. Routine maintenance as specified and in accordance with the Seller's product manuals and supplemental instructions and guidelines as set out in full at www.waterax.com/eng/warranty;
- d. Failure due to compliance with a specification or design provided or required by Purchaser;

- e. Failure due to improper operation, excess pressure, excess voltage, abuse, misuse, negligence or accidents or other similar causes;
- f. Failure due to operator error;
- g. Damage during or after shipment and failure attributable thereto or resulting there from;
- h. Failure attributable to or resulting from the failure or substandard, inadequate or improper performance of any part, component or equipment not supplied by the Seller;
- i. Failure attributable to or resulting from the failure or substandard, inadequate or improper performance of any third party part, component, product or equipment, whether or not combined, packaged, incorporated, installed or used with a Seller brand part, component, product or equipment.

3. Claim Notice and Claim Documentation:

- a. The Seller shall have no obligation under this Warranty unless the Purchaser promptly notifies the Seller in writing (a "Claim Notice") within the Warranty Period of any claim under this Warranty;
- b. Claim Notices must identify the Product claimed to be defective (including the serial number if applicable) and describe in reasonable detail the circumstances surrounding the failure;
- c. The Purchaser shall also complete and comply with the Seller's Returned Material's Authorization ("RMA") form and procedures. The Purchaser shall request such form in the Claim Notice;
- d. The Purchaser shall provide documentation in support of its claim as the Seller may reasonably request. Such documentation may include, but is not limited to, in service dates, run hours and service and repair records;

4. Claim Procedure:

- a. Upon the reception of a Claim Notice, the Seller shall have the right to physically inspect the Product claimed to be defective;
- b. If requested by the Seller, the Purchaser shall deliver the Product claimed to be defective to the Seller at its manufacturing facility or to any other party or location designated by the Seller;
- c. The Product must be delivered to the Seller within 30 days of issuance of the RMA;
- d. The RMA number must be included with the Product when delivered to the Seller;

- e. Failure to make timely delivery to the Seller of the Product claimed to be defective shall void this Warranty;
- f. The Purchaser or its customer shall be responsible for all freight and shipping charges in connection with the delivery of the Product claimed to be defective to the Seller and the delivery of repaired or replacement Product or parts to the Purchaser;
- g. The Product claimed to be defective must be shipped by the Purchaser freight prepaid;
- h. Repaired and replacement Product and parts thereof will be shipped to the Purchaser freight collect;
- i. The Purchaser shall bear all risk of loss or damage during shipment.

5. Repaired and Replacement Product:

- a. If requested to do so by the Purchaser, the Seller may, at its sole option and in its sole discretion, supply a replacement Product or part to the Purchaser prior to making a final determination as to whether Warranty Coverage is available;
- b. If the Seller ultimately determines that no Warranty Coverage is available for a Product claimed to be defective, the Purchaser shall have the option of either:
 - i. Having the Product returned to it freight collect, without repair or replacement, or;
 - ii. If Seller determines that the Product is repairable, have the Product repaired by Seller or another party designated by it on a time and materials basis at Seller's then current standard charges for non-warranty repairs and then returned to Purchaser freight collect.
- c. The Seller reserves the right to use reconditioned parts for Warranty repairs and to use reconditioned Products for Warranty replacements;
- d. Repaired Product and replacement Product shall be warranted only for the remainder of the original Warranty Period.

6. Limits of Liability:

Seller's warranty as set forth herein is seller's sole and exclusive warranty and is in lieu of all other warranties, express or implied, including, but not limited to, all warranties of merchantability, quality, course of dealing, usage of trade, fitness for a particular purpose and non-infringement. The rights and remedies set forth herein are the sole and exclusive rights and remedies against seller, except for the specific liabilities and obligations provided herein, seller shall have no liability or obligation with respect to any product claimed to be defective in any manner.

PRODUCT SPECIFIC WARRANTY TERMS AND CONDITIONS

PRODUCT ¹	WARRANTY PERIOD	COVERAGE ²
4-Stroke Powered Portable Pumps	Two (2) years from date of shipment of Product to original Purchaser	Repair or replacement of Product that Seller determines failed during Warranty period due to a defect in material or workmanship. Seller offers no warranty with respect to engines. Any warranty with respect to engines is limited to whatever warranty may be provided by the engine manufacturer.
2-Stroke Powered Portable Pumps	Earlier of one (1) year from date of shipment of Product to original Purchaser or One hundred (100) run hours	Repair or replacement of Product that Seller determines failed during the Warranty period due to a defect in material or workmanship.
Backpack Pumps	One (1) Year from date of shipment of Product to original Purchaser	Repair or replacement of Product that Seller determines failed during the Warranty period due to a defect in material or workmanship.
Skid Units	One (1) Year from date of shipment of Product to original Purchaser	Repair or replacement of Product that Seller determines failed during the Warranty period due to a defect in material or workmanship. Seller makes no warranty with respect tank and plumbing accessories. Any such warranty with respect to tanks and plumbing accessories is limited to the warranty coverage, if any, provided by the respective manufacturer.
Control Panels, Electronics, Manifolds	Two (2) years from date of shipment of Product to original Purchaser	Repair or replacement of Product that Seller determines failed during the Warranty period due to a defect in material or workmanship.
Genuine Parts	Ninety (90) days commencing on the date when Product is first placed in service.	Repair or replacement of Product that Seller determines failed during the Warranty period due to a defect in material or workmanship.

¹ When Products are combined to form a module or package, each Product will have its own separate Warranty Period and Warranty Coverage.

² For each Product, Seller will have the option to refund to Purchaser (in cash or by credit) the purchase price that Seller was paid for such Product, less depreciation determined on a straight line basis over the Warranty Period, in lieu of repair or replacement (including, when applicable, labor). The decision whether to repair, replace or refund (and, if there is a refund, whether to refund in cash or by credit) shall be made by Seller in its sole discretion.

TERMS AND CONDITIONS OF SALE

ORDER BY PHONE, FAX, MAIL OR EMAIL

WATERAX strives to make ordering as simple as possible. A toll free phone call to your local sales representative is all it requires. When you call, you'll speak to a highly trained and experienced sales representative who will quickly and accurately process your order right over the phone. We will gladly process all orders faxed, mailed or e-mailed.

Prices

All prices are subject to change without notice. Feel free to call, fax, e-mail or write to our sales personnel for current pricing information. All prices are FOB WATERAX's warehouse/shipping point (Incoterms 2000 revision) unless specifically quoted otherwise.

International Sale of Goods Convention

Please note that we expressly exclude the application of the United Nations Convention on Contracts for the International Sale of Goods, whose terms therefore do not apply to any sales made to you by us.

Payment Terms

Net 30 days, subject to credit approval. Past due amounts are subject to late payment charge of 1.5% per 30 days (being 18% on an annual basis), or service charge at the maximum rate allowed by applicable state or provincial law. Charges (including reasonable solicitor and other out of pocket costs) incurred in the collection of invoices owed will be the sole responsibility of the buyer.

Minimum Charge

We will be pleased to accept all orders. Due to the cost of handling an order, a \$45.00 service charge, plus any applicable taxes and/or transportation charges, will apply to all orders of less than \$250.00. The minimum order will be waived if merchandise is purchased on credit card.

Credit Card Payment

WATERAX accepts payment by credit card (Visa or MasterCard) up to a maximum of \$25,000 per order. A surcharge of 3.5% will apply to any credit card charge over \$25,000. Maximum amount per credit card transaction is \$50,000.

Delivery

We strive to maintain an extensive inventory to service your needs. Every effort will be made to ship in a timely manner. Notwithstanding anything to the contrary set forth in any purchase order or distributor agreement, passage of title and risk of loss will transfer to the buyer from WATERAX upon shipment from any designated WATERAX warehouse or supplier location, unless otherwise explicitly agreed upon by WATERAX and the buyer in writing for a specific shipment (in which case such exception only applies to the particular shipment in question and not any subsequent shipments).

Shipments will be made freight prepaid with shipping and freight charges added to the invoice unless buyer freight account number is provided. We may make partial shipments and each shipment may be treated separately for purposes of invoicing. Our count and weight taken at the shipping point shall govern. Please note that delivery schedules are approximate and not guaranteed. We assume no responsibility for any delays in delivery.

Shortages or Damaged Merchandise

Any shortage, damage or error in shipment should be reported to us immediately upon receipt of good and at the latest within 10 days after delivery. All packages should be carefully inspected for visible damage prior to acceptance from the carrier and delivery refused or damage noted when signing for receipt of packages.

Returned Goods

Please contact our customer service department with full details concerning the return of any goods and the issuance of a Return Goods Authorization number (RGA). Returned Goods will not be accepted without a valid RGA number. Material returned for reasons other than defective replacement will carry a handling and restocking charge equal to 20% of the invoice price of such merchandise. Material must be in new and original condition subject to inspection, and returned freight prepaid.

Note: all special orders, being non-stocked items purchased on special order are to be considered non-cancellable and non-returnable. Such sales are therefore final.





WATERAX INC.

6635 Henri-Bourassa W.
Montreal, QC H4R 1E1

T 514 637-1818
F 514 637-3985
TF 1 855 616-1818

[**shop.waterax.ca**](http://shop.waterax.ca)

WATERAX CORP.

3801 NE 109TH Ave, Suite A
Vancouver, WA 98682, USA

T 360-574-1818
F 360-571-0443
TF 1 855 616-1818

[**shop.waterax.com**](http://shop.waterax.com)



[**info@waterax.com**](mailto:info@waterax.com)

[**www.waterax.com**](http://www.waterax.com)

Distributed by:

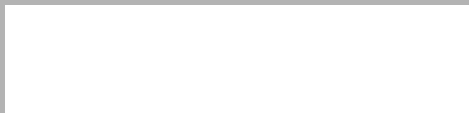

WATERAX 
WE MOVE WATER